

STATE: TEXAS
 COUNTY: BREWSTER
 FOR NPS USE ONLY
 ENTRY DATE: SEP 3 1974

**NATIONAL REGISTER OF HISTORIC PLACES
INVENTORY - NOMINATION FORM
FOR FEDERAL PROPERTIES**

(Type all entries - complete applicable sections)

H13 no utm

1. NAME

COMMON: Sublett Farm, Stone Residence, Dorgan Residence
 AND/OR HISTORIC: Rancho Estelle *use this*

2. LOCATION

STREET AND NUMBER: *San Rio Grande*
 (see continuation sheet)
 CITY OR TOWN: Big Bend National Park
 CONGRESSIONAL DISTRICT: 16th District - Texas
 STATE: Texas CODE: 48 COUNTY: Brewster CODE: 043

3. CLASSIFICATION

CATEGORY (Check One)	OWNERSHIP	STATUS	ACCESSIBLE TO THE PUBLIC
<input checked="" type="checkbox"/> District <input type="checkbox"/> Site <input type="checkbox"/> Object	<input checked="" type="checkbox"/> Public <input type="checkbox"/> Private <input type="checkbox"/> Both	<input type="checkbox"/> Occupied <input checked="" type="checkbox"/> Unoccupied <input type="checkbox"/> Preservation work in progress	<input checked="" type="checkbox"/> Yes: <input type="checkbox"/> Restricted <input type="checkbox"/> Unrestricted <input type="checkbox"/> No
PRESENT USE (Check One or More as Appropriate)			
<input type="checkbox"/> Agricultural <input type="checkbox"/> Commercial <input type="checkbox"/> Educational <input type="checkbox"/> Entertainment	<input checked="" type="checkbox"/> Government <input type="checkbox"/> Industrial <input type="checkbox"/> Military <input type="checkbox"/> Museum	<input checked="" type="checkbox"/> Park <input type="checkbox"/> Private Residence <input type="checkbox"/> Religious <input type="checkbox"/> Scientific	<input type="checkbox"/> Transportation <input type="checkbox"/> Other (Specify) _____ _____

4. AGENCY

U. S. Government, National Park Service, Department of the Interior
 REGIONAL HEADQUARTERS: (If applicable) Southwest Regional Office
 CITY OR TOWN: Santa Fe, New Mexico
 STREET AND NUMBER: P. O. Box 728
 STATE: New Mexico CODE: 35

5. LOCATION OF LEGAL DESCRIPTION

COURTHOUSE, REGISTRY OF DEEDS, ETC.: Courthouse, Brewster County
 STREET AND NUMBER:
 CITY OR TOWN: Alpine, Texas
 STATE: Texas CODE: 48

6. REPRESENTATION IN EXISTING SURVEYS

TITLE OF SURVEY: Historic American Buildings Inventory
 DATE OF SURVEY: 10/64 Federal State County Local
 DEPOSITORY FOR SURVEY RECORDS: Library of Congress
 STREET AND NUMBER:
 CITY OR TOWN: Washington, D.C. CODE: 11

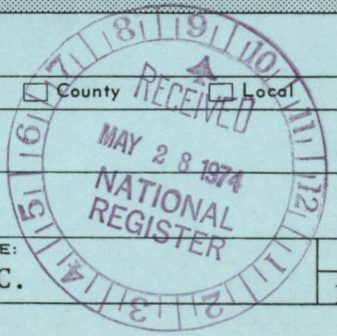

SEE INSTRUCTIONS

STATE: Texas
 COUNTY: Brewster
 ENTRY NUMBER: SEP 3 1974
 DATE: _____
 FOR NPS USE ONLY

7. DESCRIPTION

CONDITION

(Check One)

Excellent
 Good
 Fair
 Deteriorated
 Ruins
 Unexposed

(Check One)

Altered
 Unaltered

(Check One)

Moved
 Original Site

DESCRIBE THE PRESENT AND ORIGINAL (if known) PHYSICAL APPEARANCE

The exact number, type, and location of structures at Rancho Estelle are unknown. Those structures that do remain are all in various states of ruin. Some stabilization work has been done, but all are presently endangered. They are as follows:

BBH-12, Sublett Farm House: This structure was a one-story adobe house having a cane and viga roof. It contained 2 rooms separated by a central hall, and a covered porch across the front of the structure.

BBH-13, Farm Hand's Casita: Typical Mexican farm worker's adobe home. One-story adobe structure, walls capped with stone. Cane and viga roof. Contained 2 rooms.

BBH-14, Adobe Shed: One-story, single room adobe structure which served variously as a warehouse and store. The roof is gone and the walls are deteriorating.

BBH-15, Stone Farm House: This stone structure consisted of 2 apartments separated by a day room, at the end of which was an outdoor cooking area and fireplace. Substantial stonework walls are still fairly intact, but the roof is now gone. The structure probably housed farm workers.

BBH-139, Dorgan Residence: One-story ranch home of adobe and stone wall construction. The core of the house is a 30' x 30' living room with 3 smaller rooms and a porch extending from the central square giving a total floor space of ca. 1,200 sq. ft. A unique feature of the construction is the large square main room with a 2-way fireplace in the center made of petrified wood and acting as a structural pier supporting huge log beams extending to the corners of the room forming a hipped, almost flat, roof with a large chimney at the apex. The house is now roofless and in ruins. Lintels over the main entrance are carefully selected cured logs forming segmental arches. Floors are concrete slab. Floor plan consists of the large main room and smaller rooms on the northeast and southwest sides. The southeast side opened to a covered terrace or ramada overlooking the flood plain of the Rio Grande and Mexico to the south. Walls plastered exterior and interior. Mr. Dorgan was said to be the son-in-law of James Sublett and an associate in the enterprise.

Proposed level of treatment: Preservation.

Estimated cost of treatment: \$15,000 initially, \$1,000 P/A thereafter based on 1973 costs.

SEE INSTRUCTIONS

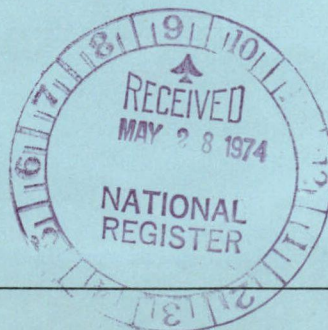

NATIONAL REGISTER OF HISTORIC PLACES
INVENTORY - NOMINATION FORM

(Continuation Sheet)

STATE TEXAS	
COUNTY BREWSTER	
FOR NPS USE ONLY	
ENTRY NUMBER	DATE
SEP 3	1974

(Number all entries)

2. LOCATION

Rancho Estelle is located near the Rio Grande River between Castalon and Santa Elena Canyon. The structures are situated on the north side of Park Route 9 approximately 4.5 miles from the Castalon junction.

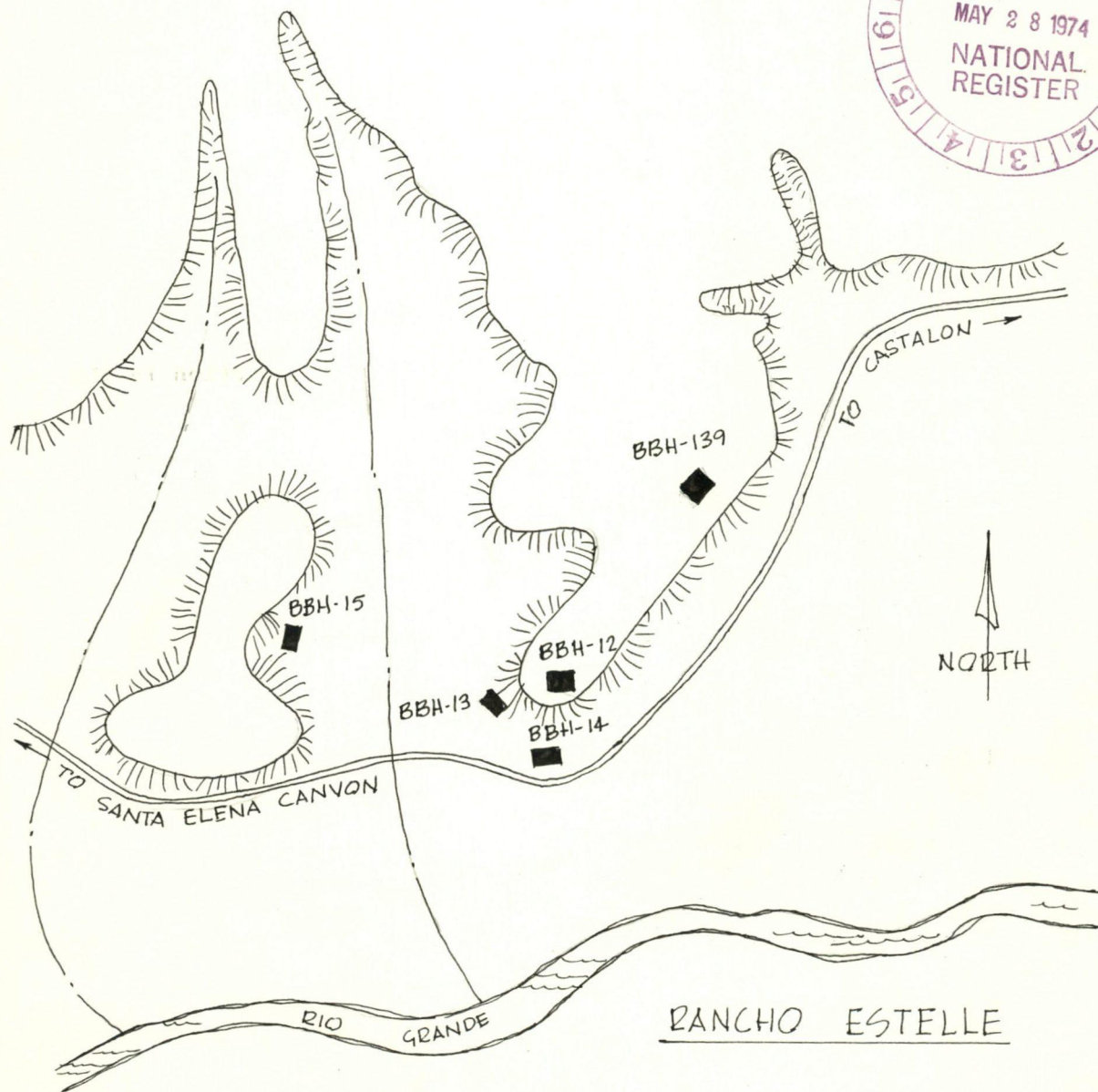

RANCHO ESTELLE

8. SIGNIFICANCE

PERIOD (Check One or More as Appropriate)

- Pre-Columbian 16th Century 18th Century 20th Century
 15th Century 17th Century 19th Century

SPECIFIC DATE(S) (If Applicable and Known) Early 1900's

AREAS OF SIGNIFICANCE (Check One or More as Appropriate)

- | | | | |
|--|---|--|--|
| <input type="checkbox"/> Aboriginal | <input type="checkbox"/> Education | <input type="checkbox"/> Political | <input type="checkbox"/> Urban Planning |
| <input type="checkbox"/> Prehistoric | <input type="checkbox"/> Engineering | <input type="checkbox"/> Religion/Philosophy | <input type="checkbox"/> Other (Specify) _____ |
| <input type="checkbox"/> Historic | <input type="checkbox"/> Industry | <input type="checkbox"/> Science | _____ |
| <input checked="" type="checkbox"/> Agriculture | <input type="checkbox"/> Invention | <input type="checkbox"/> Sculpture | _____ |
| <input checked="" type="checkbox"/> Architecture | <input type="checkbox"/> Landscape Architecture | <input type="checkbox"/> Social/Humanitarian | _____ |
| <input type="checkbox"/> Art | <input type="checkbox"/> Literature | <input type="checkbox"/> Theater | _____ |
| <input type="checkbox"/> Commerce | <input type="checkbox"/> Military | <input type="checkbox"/> Transportation | _____ |
| <input type="checkbox"/> Communications | <input type="checkbox"/> Music | | |
| <input type="checkbox"/> Conservation | | | |

STATEMENT OF SIGNIFICANCE

James Sublett was one of the first settlers in the Big Bend area to actively farm the Rio Grande flood plain on a large scale. In partnership with Clyde Buttrill, he farmed the area and operated the store at what came to be known as Castalon or La Harmonia Farm, several miles downstream.

When the Buttrill-Sublett partnership broke up, Sublett purchased 4 sections of land at the present location and under the name of Grand Canyon Farms, Sublett and his associates operated what came to be known as Rancho Estelle.

Rancho Estelle derives its primary significance from its importance in depicting the flood plain farming activity along the Rio Grande, and is a good and representative example of such. Additionally, the Dorgan House has outstanding architectural merit among remaining structures of its time, type, and place.

SEE INSTRUCTIONS

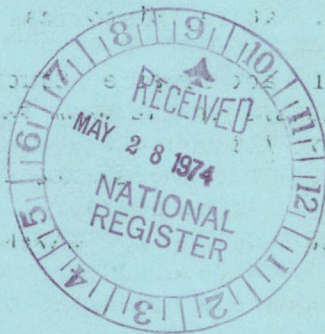

9. MAJOR BIBLIOGRAPHICAL REFERENCES

Casey, Clifford B. Soldiers, Ranchers, and Miners in the Big Bend. National Park Service, U. S. Department of the Interior, 1969.

Brown, William E. and Wauer, Roland H. Historic Resources Management Plan, Big Bend National Park. National Park Service, U. S. Department of the Interior, 1968.

10. GEOGRAPHICAL DATA

LATITUDE AND LONGITUDE COORDINATES DEFINING A RECTANGLE LOCATING THE PROPERTY			O R	LATITUDE AND LONGITUDE COORDINATES DEFINING THE CENTER POINT OF A PROPERTY OF LESS THAN TEN ACRES		
CORNER	LATITUDE	LONGITUDE		LATITUDE	LONGITUDE	
	Degrees Minutes Seconds	Degrees Minutes Seconds		Degrees Minutes Seconds	Degrees Minutes Seconds	
NW	29° 09' 30"	130° 35' 00"				
NE	29° 09' 30"	130° 34' 27"				
SE	29° 09' 03"	130° 34' 27"				
SW	29° 09' 03"	130° 35' 00"				

APPROXIMATE ACREAGE OF NOMINATED PROPERTY: 135

LIST ALL STATES AND COUNTIES FOR PROPERTIES OVERLAPPING STATE OR COUNTY BOUNDARIES

STATE:	CODE	COUNTY:	CODE

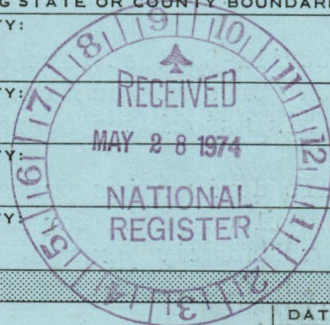

11. FORM PREPARED BY

NAME AND TITLE:
David G. Battle, Historical Architect

DATE:
February, 1974

BUSINESS ADDRESS:
National Park Service, Southwest Regional Office

STREET AND NUMBER:
P. O. Box 728

PHONE: (505) 988-6501

CITY OR TOWN:
Santa Fe

STATE:
New Mexico

CODE:
35

12. CERTIFICATION OF NOMINATION

State Liaison Officer recommendation:

Yes
 No
 None

Julia Salinas
State Liaison Officer Signature

In compliance with Executive Order 11593, I hereby nominate this property to the National Register, certifying that the State Liaison Officer has been allowed 90 days in which to present the nomination to the State Review Board and to evaluate its significance. The recommended level of significance is National State Local

John Anthony
Federal Representative Signature

5/20/74
Date

REGIONAL DIRECTOR
Title

NATIONAL REGISTER VERIFICATION

I hereby certify that this property is included in the National Register.

J.P. Mortensen
Director, Office of Archeology and Historic Preservation

Date *9/2/74*

ATTEST:

Charles H. Smith
Keeper of The National Register

Date *8-30-74*

SEE INSTRUCTIONS

Sublett Farmy Stone Residence, Doxgan Residence -- Texas

WORKING NUMBER 5.28.74.857

TECH REVIEW

Photos 5
Maps 1

74000280

CONTROL REVIEW

OK

cm
6.4.
74

HISTORIAN

ARCHITECTURAL HISTORIAN

This has some serious problems...
see Return sheet: a possible reject? Hujand
8/1/74

ARCHEOLOGIST

Need specific - if possible - dates of occupation
on Rancho Estrella. And what happened to
property after Sublett?

Return
M. BARNES
18 Jul 74

REVIEW UNIT CHIEF

Return
Cole
8/26/74

BRANCH CHIEF

KEEPER

This is adequate and does
not need to be returned

Hunt
for Montgoth
8-30-74

National Register write-up 11/74

Send-back _____

Federal Register entry Oct. 1, 1974

Re-submit _____

Entered

SEP 3 1974

TEXAS HISTORICAL

COMMISSION

TRUETT LATIMER
EXECUTIVE DIRECTOR

P. O. BOX 12276
AUSTIN TEXAS 78711

March 17, 1981

Joy Bush, Carol Ebright
Archeologists
Heritage Conservation and Recreation Service
National Register Department
Pension Building
440 G Street NW
Washington, D.C. 20243

Dear Joy and Carol:

Review of National Register site files here in Austin has uncovered some typographical errors in older nominations. Included with this letter are corrections in the form of continuation sheets for each of the files in question. The sites are:

1. Mission Nuestra (Victoria County) Item 10
2. Geddis Canyon (Terrell County) Item 1 and Sketch Map
3. Hinõjosa Site (Jim Wells County) Item 1
4. Sublett Farm (Brewster County) Item 10
5. Castalon Site (Brewster County) Item 10

Thank you for the consideration.

Sincerely,

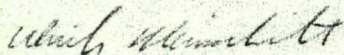

Ulrich Kleinschmidt
Archeologist
National Register Program
Austin, Texas

The State Agency for Historic Preservation

UNITED STATES DEPARTMENT OF THE INTERIOR
NATIONAL PARK SERVICE

FOR NPS USE ONLY

RECEIVED *March 20, 1981*

DATE ENTERED

**NATIONAL REGISTER OF HISTORIC PLACES
INVENTORY -- NOMINATION FORM**

CONTINUATION SHEET

ITEM NUMBER 10 PAGE 1

Sublett Farm, Stone Residence, Dorgan Residence (Brewster County,
Texas) (On Register 9/3/74).

Longitude Coordinates were typed incorrectly and should read:

NW 103 35 00
NE 103 34 27
SE 103 34 27
SW 103 35 00

All other references are correct.



STATE	TEXAS	
COUNTY	BREWSTER	
FOR NPS USE ONLY		
ENTRY NUMBER		DATE
		SEP 3 1974

**NATIONAL REGISTER OF HISTORIC PLACES
PROPERTY PHOTOGRAPH FORM**

(Type all entries - attach to or enclose with photograph)

SEE INSTRUCTIONS

1. NAME

COMMON: Sublett Farm, Stone Residence, Dorgan Residence
AND/OR HISTORIC: Rancho Estelle

2. LOCATION

STREET AND NUMBER:
See continuation sheet

CITY OR TOWN:
Big Bend National Park

STATE:	CODE	COUNTY:	CODE
Texas	48	Brewster	043

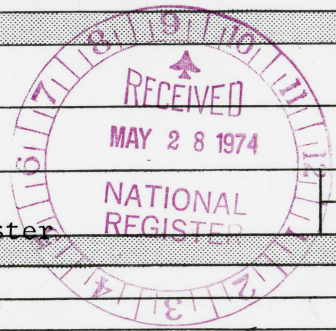

3. PHOTO REFERENCE

PHOTO CREDIT: Historic American Buildings Survey
DATE OF PHOTO: 1964
NEGATIVE FILED AT:
National Park Service, Southwest Regional Office, Santa Fe, NM

4. IDENTIFICATION

DESCRIBE VIEW, DIRECTION, ETC.
Stone Farm House, BBH-15
#1 of 5

PROPERTY OF THE NATIONAL REGISTER



UNITED STATES DEPARTMENT OF THE INTERIOR
NATIONAL PARK SERVICE

STATE	Texas	
COUNTY	Brewster	
FOR NPS USE ONLY		
ENTRY NUMBER	DATE	
SEP 3 1974		

NATIONAL REGISTER OF HISTORIC PLACES

PROPERTY PHOTOGRAPH FORM

(Type all entries - attach to or enclose with photograph)

#2

SEE INSTRUCTIONS

1. NAME

COMMON: Sublett Farm, Stone Residence, Dorgan Residence

AND/OR HISTORIC: Rancho Estelle

2. LOCATION

STREET AND NUMBER:

(See continuation Sheet

CITY OR TOWN:

Big Bend National Park

STATE:

Texas

CODE

48

COUNTY:

Brewster

CODE

043

3. PHOTO REFERENCE

PHOTO CREDIT: David G. Battle

DATE OF PHOTO: 2/13/64

NEGATIVE FILED AT:

National Park Service, Southwest Regional Office, Santa Fe, New Mexico

4. IDENTIFICATION

DESCRIBE VIEW, DIRECTION, ETC.

Sublett Farm Hand's Casita, BBH-13

#2 of 5

PROPERTY OF THE NATIONAL REGISTER

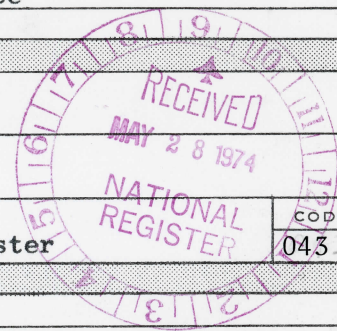



UNITED STATES DEPARTMENT OF THE INTERIOR
NATIONAL PARK SERVICE

**NATIONAL REGISTER OF HISTORIC PLACES
PROPERTY PHOTOGRAPH FORM**

(Type all entries - attach to or enclose with photograph)

STATE	
TEXAS	
COUNTY	
BREWSTER	
FOR NPS USE ONLY	
ENTRY NUMBER	DATE
SEP 3	1974

SEE INSTRUCTIONS

1. NAME

COMMON: Sublett Farm, Stone Residence, Dorgan Residence
AND/OR HISTORIC: Rancho Estelle

2. LOCATION

STREET AND NUMBER:
See continuation sheet
CITY OR TOWN:
Big Bend National Park

STATE:	CODE	COUNTY:	CODE
Texas	48	Brewster	043

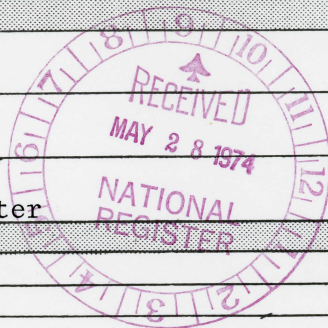

3. PHOTO REFERENCE

PHOTO CREDIT: Historic American Buildings Survey
DATE OF PHOTO: 1964
NEGATIVE FILED AT:
National Park Service, Southwest Regional Office, Santa Fe, NM

4. IDENTIFICATION

DESCRIBE VIEW, DIRECTION, ETC.
Dorgan Residence, BBH-139

#3 of 5

PROPERTY OF THE NATIONAL REGISTER



UNITED STATES DEPARTMENT OF THE INTERIOR
NATIONAL PARK SERVICE

NATIONAL REGISTER OF HISTORIC PLACES
PROPERTY PHOTOGRAPH FORM

(Type all entries - attach to or enclose with photograph)

STATE Texas	
COUNTY Brewster	
FOR NPS USE ONLY	
ENTRY NUMBER	DATE
	SEP 3 - 1974

1. NAME

COMMON: **Sublett Farm, Stone Residence, Dorgan Residence**
AND/OR HISTORIC: **Rancho Estelle**

2. LOCATION

STREET AND NUMBER:
(See continuation sheet)

CITY OR TOWN:
Big Bend National Park

STATE: Texas	CODE 48	COUNTY: Brewster	CODE 043
------------------------	-------------------	----------------------------	--------------------

3. PHOTO REFERENCE

PHOTO CREDIT: **Historic American Buildings Survey**

DATE OF PHOTO: **1964**

NEGATIVE FILED AT:
National Park Service, Southwest Regional Office, Santa Fe, New Mexico

4. IDENTIFICATION

DESCRIBE VIEW, DIRECTION, ETC.
4 of 5

Sublette Farm House, BBH-12

PROPERTY OF THE NATIONAL REGISTER

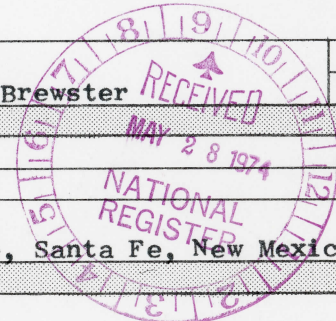

SEE INSTRUCTIONS

#4



**NATIONAL REGISTER OF HISTORIC PLACES
PROPERTY PHOTOGRAPH FORM**

(Type all entries - attach to or enclose with photograph)

STATE TEXAS	
COUNTY BREWSTER	
FOR NPS USE ONLY	
ENTRY NUMBER SEP 3 1974	DATE

SEE INSTRUCTIONS

1. NAME

COMMON: Sublett Farm, Stone Residence, Dorgan Residence
AND/OR HISTORIC: Rancho Estelle

2. LOCATION

STREET AND NUMBER:
See continuation sheet

CITY OR TOWN:
Big Bend National Park

STATE: Texas	CODE 48	COUNTY: Brewster	CODE 043
-----------------	------------	---------------------	-------------

3. PHOTO REFERENCE

PHOTO CREDIT: David G. Battle

DATE OF PHOTO: February 13, 1964

NEGATIVE FILED AT:
National Park Service, Southwest Regional Office, Santa Fe, NM

4. IDENTIFICATION

DESCRIBE VIEW, DIRECTION, ETC.
Sublett Farm Shed, BBH-14

PROPERTY OF THE NATIONAL REGISTER

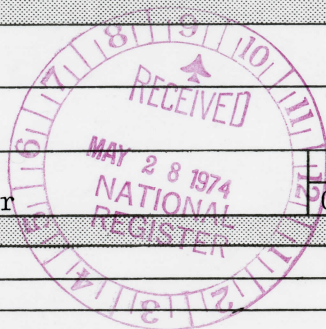

#5

#5 #5

NATIONAL REGISTER OF HISTORIC PLACES
PROPERTY MAP FORM

(Type all entries - attach to or enclose with map)

STATE	
Texas	
COUNTY	
Brewster	
FOR NPS USE ONLY	
ENTRY NUMBER	DATE
SEP 3	1974

SEE INSTRUCTIONS

1. NAME			
COMMON: Sublett Farm, Stone Residence, Dorgan Residence			
AND/OR HISTORIC: Rancho Estelle			
2. LOCATION			
STREET AND NUMBER:			
(See continuation sheet)			
CITY OR TOWN:			
Big Bend National Park			
STATE:	CODE	COUNTY:	CODE
Texas	48	Brewster	043
3. MAP REFERENCE			
SOURCE: USGS Advance Manuscript Print, Stage 4, 7.5' Quadrangle,			
Terlingua Abaja, N.E., Texas			
SCALE: 1:24,000			
DATE:			
4. REQUIREMENTS			
TO BE INCLUDED ON ALL MAPS			
1. Property boundaries where required.			
2. North arrow.			
3. Latitude and longitude reference.			

ADVANCE PROOF
SUBJECT TO CORRECTION

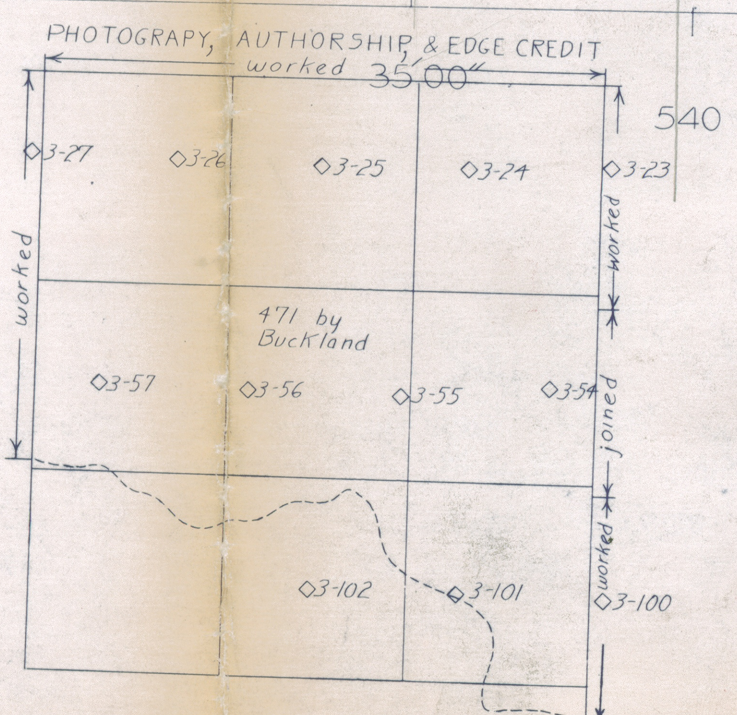
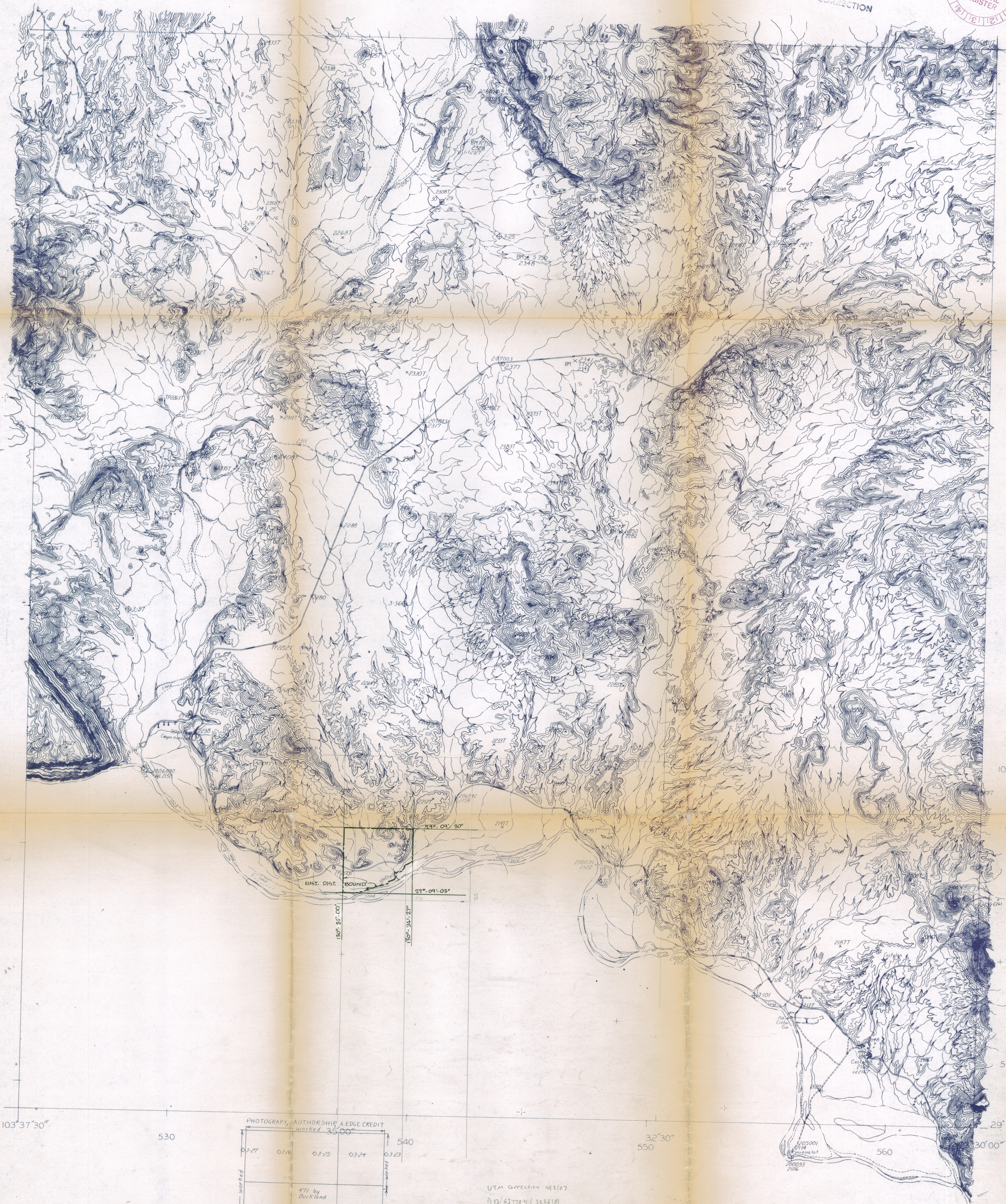

- UTM correction 10/21/07
- 1) 13/037784 / 3226151
 - 2) 13/038669 / 3226158
 - 3) 13/038679 / 3225353
 - 4) 13/037794 / 3225324

TERLINGUA ABAJA NE BIG BEND TEXAS 2703

TERLINGUA ABAJA NE

ENTRIES IN THE NATIONAL REGISTER

STATE ~~FLORIDA~~ TEXAS

Date Entered SEP 3 1974

Name

Location

Rancho Estelle
~~Sublett Farm, Stone Residence, Dorgan
Residence~~

~~Big Bend National Park
Brewster County~~

*Richard,
change name
M.*

Also Notified

Hon. John G. Tower
Hon. Lloyd M. Bentsen
Hon. O. Clark Fisher
Mr. Douglas Wheeler (FWP), Deputy
Asst. Secretary for Fish and
Wildlife and Parks
Mr. Robert M. Utley, Asst. Director,
Park Historic Preservation
Regional Director, Southwest Region

State Historic Preservation Officer
Mr. Truett Latimer
Executive Director
Texas State Historical Survey Committee
Post Office Box 12276
Capitol Station
Austin, Texas 78711

9/5/74

MMott/row

PR