

HB no utm

STATE:	TEXAS
COUNTY:	CULBERSON
FOR NPS USE ONLY	
ENTRY DATE	OCT 9 1974

**NATIONAL REGISTER OF HISTORIC PLACES
INVENTORY - NOMINATION FORM
FOR FEDERAL PROPERTIES**

(Type all entries - complete applicable sections)

1. NAME

COMMON:
Pinery Station

AND/OR HISTORIC:
Butterfield Stage Station

2. LOCATION

STREET AND NUMBER:
(See continuation sheet) off U.S. 62/180

CITY OR TOWN: Guadalupe Mountain National Park

CONGRESSIONAL DISTRICT: 16th District - Texas

STATE: Texas CODE: 48 COUNTY: Culberson CODE: 109

3. CLASSIFICATION

CATEGORY (Check One)	OWNERSHIP	STATUS	ACCESSIBLE TO THE PUBLIC
<input type="checkbox"/> District <input type="checkbox"/> Site <input type="checkbox"/> Object <input checked="" type="checkbox"/> Building <input type="checkbox"/> Structure	<input checked="" type="checkbox"/> Public <input type="checkbox"/> Private <input type="checkbox"/> Both Public Acquisition: <input type="checkbox"/> In Process <input type="checkbox"/> Being Considered	<input type="checkbox"/> Occupied <input checked="" type="checkbox"/> Unoccupied <input type="checkbox"/> Preservation work in progress	<input checked="" type="checkbox"/> Yes: <input type="checkbox"/> Restricted <input type="checkbox"/> Unrestricted <input type="checkbox"/> No
PRESENT USE (Check One or More as Appropriate)			
<input type="checkbox"/> Agricultural <input type="checkbox"/> Commercial <input type="checkbox"/> Educational <input type="checkbox"/> Entertainment	<input checked="" type="checkbox"/> Government <input type="checkbox"/> Industrial <input type="checkbox"/> Military <input type="checkbox"/> Museum	<input checked="" type="checkbox"/> Park <input type="checkbox"/> Private Residence <input type="checkbox"/> Religious <input type="checkbox"/> Scientific	<input type="checkbox"/> Transportation <input type="checkbox"/> Other (Specify) _____ _____ _____

4. AGENCY

U. S. Government, National Park Service, Department of the Interior

REGIONAL HEADQUARTERS: (If applicable) Southwest Regional Office of the Interior

STREET AND NUMBER: P. O. Box 728

CITY OR TOWN: Santa Fe, STATE: New Mexico CODE: 35

5. LOCATION OF LEGAL DESCRIPTION

COURTHOUSE, REGISTRY OF DEEDS, ETC.: Culberson County Court House

STREET AND NUMBER:

CITY OR TOWN: Van Horn STATE: Texas CODE: 48

6. REPRESENTATION IN EXISTING SURVEYS

TITLE OF SURVEY: None

DATE OF SURVEY: Federal State County Local

DEPOSITORY FOR SURVEY RECORDS:

STREET AND NUMBER:

CITY OR TOWN: STATE: CODE:

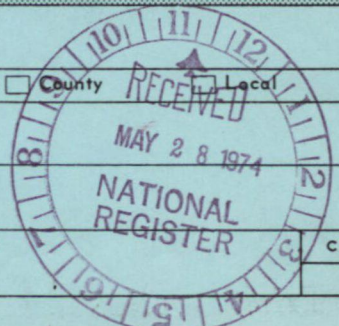

SEE INSTRUCTIONS

STATE:	Texas
COUNTY:	Culberson
ENTRY NUMBER	OCT 9 1974
DATE	

FOR NPS USE ONLY

7. DESCRIPTION

CONDITION	(Check One)					
	<input type="checkbox"/> Excellent	<input type="checkbox"/> Good	<input type="checkbox"/> Fair	<input type="checkbox"/> Deteriorated	<input checked="" type="checkbox"/> Ruins	<input type="checkbox"/> Unexposed
	(Check One)			(Check One)		
	<input type="checkbox"/> Altered	<input checked="" type="checkbox"/> Unaltered		<input type="checkbox"/> Moved	<input checked="" type="checkbox"/> Original Site	

DESCRIBE THE PRESENT AND ORIGINAL (if known) PHYSICAL APPEARANCE

"From surveys, measurements, and other details of construction carefully collected here, and from the ruins of the other rock-built stations along the route, it is possible after comparing the results to form a very accurate picture of the original station. From these data a model restoration on a scale of one-quarter inch to one foot has been constructed by the author from which the following description of Pinery Station is taken. The inside dimensions of the high-walled rectangular enclosure were approximately 57 feet 4 inches long by 41 feet 2 inches wide. The walls, built of limestone slabs laid in mud or adobe, were 30 inches thick and 11 feet high. Attached to the inside north and east walls, lean-to fashion, were 3 rooms: one, 10 by 10 feet in the corner and two, 10 by 14 feet, adjoining. There was one chimney with a double fireplace in it. The rooms were mud roofed; i.e., the roof beams were covered with wattles and thatch, overlaid with a thick layer of mud or adobe. In the southeast corner of the enclosure protected by a thatched shelter there was a repair shop and smithy. The station was supplied with water through an acequia or open ditch to a tank located in the northwest corner of the enclosure. There was a stockade built of heavy pine posts which protected the main entrance on the south wall, and on the north end there was a stone-walled corral, 67 by 35 feet and 5 feet in height."¹

Today the Pinery is in a state of ruins. The northwest wall of the main enclosure is the only one still standing in any substantial form, and it has a decided list which places it in danger of collapse before long. Enough rubble remains from the rest of the walls to trace the outline of the two main enclosures. Little trace remains of the stockade, stage road and acequia.

Recent acquisition of this property by the National Park Service will hopefully permit stabilization in the near future.

Recommended treatment: Excavation of site to uncover buried portions of ruins, and then preservation.

Estimated Cost: \$10,000 initially, \$1,500 P/A thereafter, based on 1973 costs.



SEE INSTRUCTIONS

¹ Conkling, Vol. 1, p. 392.

**NATIONAL REGISTER OF HISTORIC PLACES
INVENTORY - NOMINATION FORM**

(Continuation Sheet)

STATE		TEXAS
COUNTY		CULBERSON
FOR NPS USE ONLY		
ENTRY NUMBER	DATE	
		OCT 9 1974

(Number all entries)

2. LOCATION

The Pinery is located in Guadalupe Mountain National Park approximately 200 feet north of U. S. Routes 62-180 and west of the Pine Springs Highway Maintenance Station.



8. SIGNIFICANCE

PERIOD (Check One or More as Appropriate)

- Pre-Columbian 16th Century 18th Century 20th Century
 15th Century 17th Century 19th Century

SPECIFIC DATE(S) (If Applicable and Known) 1858-1859

AREAS OF SIGNIFICANCE (Check One or More as Appropriate)

- | | | | |
|--|---|--|--|
| <input type="checkbox"/> Aboriginal | <input type="checkbox"/> Education | <input type="checkbox"/> Political | <input type="checkbox"/> Urban Planning |
| <input type="checkbox"/> Prehistoric | <input type="checkbox"/> Engineering | <input type="checkbox"/> Religion/Philosophy | <input type="checkbox"/> Other (Specify) |
| <input type="checkbox"/> Historic | <input type="checkbox"/> Industry | <input type="checkbox"/> Science | _____ |
| <input type="checkbox"/> Agriculture | <input type="checkbox"/> Invention | <input type="checkbox"/> Sculpture | _____ |
| <input type="checkbox"/> Architecture | <input type="checkbox"/> Landscape Architecture | <input type="checkbox"/> Social/Humanitarian | _____ |
| <input type="checkbox"/> Art | <input type="checkbox"/> Literature | <input type="checkbox"/> Theater | _____ |
| <input type="checkbox"/> Commerce | <input type="checkbox"/> Military | <input type="checkbox"/> Transportation | _____ |
| <input checked="" type="checkbox"/> Communications | <input type="checkbox"/> Music | | |
| <input type="checkbox"/> Conservation | | | |

STATEMENT OF SIGNIFICANCE

"Pinery Station has the distinction of being the only ruin of an original company-built, Butterfield station standing on the route in close proximity to a national highway. ... The station named for the surrounding forests of pine and located but a quarter of a mile from Pine Spring, and in a region of good grazing, was one of the most favorably situated stations on the route. The location on the summit of Guadalupe Pass, ... was the highest point on the route as originally laid out. ... All the early expeditions camped here: Lieutenant Bryan on July 22, 1849, Captain March on September 10th of the same year, Commissioner Bartetton on November 10, 1850 and Captain Pope in February 1854."¹

"Pinery was the fourth of the stone fort stations constructed by the company on the route west from the Head of Concho. According to Ormsby only the palisade corral had been built at the time of the arrival here of the first west-bound Butterfield Mail in the afternoon of Tuesday, September 28, 1858. The meal provided at the station on this occasion consisted of venison pie and baked beans. The station keeper, Henry Ramstine (who was connected with the El Paso District Surveyor's office in 1855) and his helpers were living in tents at the time. The station was completed in the early part of the following November by Superintendent Glover's men."²

"The Pinery continued to be a meal and change station until in August 1859, when the route was changed to run to El Paso by way of Fort Stockton and Fort Davis. For years after its abandonment, however, even as late as 1883-1885, the old station continued to be a retreat for emigrants, freighters, and drovers, soldiers, squatters, and renegades."³

SEE INSTRUCTIONS



- 1 Conkling, Vol. 1, p. 391
- 2 Ibid, p. 391
- 3 Ibid, p. 393

9. MAJOR BIBLIOGRAPHICAL REFERENCES

Conkling, Roscoe P. and Margaret B. The Butterfield Overland Mail, 1851-1869. 3 Vols. The Authur H. Clark Co., Glendale, Cal. 1947.

Lang, Walter B. The First Overland Mail - Butterfield Trail. Copyright 1940 by Walter B. Lang.

Ormsby, Waterman L. The Butterfield Overland Mail. Edited by Lyle H. Wright and Josephine M. Bynum, Huntington Library, San Marino, Cal. 1954.

10. GEOGRAPHICAL DATA

LATITUDE AND LONGITUDE COORDINATES DEFINING A RECTANGLE LOCATING THE PROPERTY			OR	LATITUDE AND LONGITUDE COORDINATES DEFINING THE CENTER POINT OF A PROPERTY OF LESS THAN TEN ACRES		
CORNER	LATITUDE	LONGITUDE		LATITUDE	LONGITUDE	
	Degrees Minutes Seconds	Degrees Minutes Seconds		Degrees Minutes Seconds	Degrees Minutes Seconds	
NW	0 ' "	0 ' "		31° 53' 38"	104° 49' 01"	
NE	0 ' "	0 ' "				
SE	0 ' "	0 ' "				
SW	0 ' "	0 ' "				

APPROXIMATE ACREAGE OF NOMINATED PROPERTY: **1.5**

LIST ALL STATES AND COUNTIES FOR PROPERTIES OVERLAPPING STATE OR COUNTY BOUNDARIES

STATE:	CODE	COUNTY:	CODE

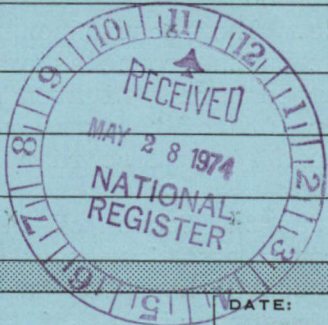

SEE INSTRUCTIONS

11. FORM PREPARED BY

NAME AND TITLE: **David G. Battle, Historical Architect** DATE: **February 7, 1974**

BUSINESS ADDRESS: **National Park Service, Southwest Regional Office**

STREET AND NUMBER: **P. O. Box 728** PHONE: **(505) 988-6501**

CITY OR TOWN: **Santa Fe, New Mexico** STATE: **New Mexico** CODE: **35**

12. CERTIFICATION OF NOMINATION

<p>State Liaison Officer recommendation:</p> <p><input checked="" type="checkbox"/> Yes <input type="checkbox"/> No <input type="checkbox"/> None</p> <p>_____ State Liaison Officer Signature</p> <p>In compliance with Executive Order 11593, I hereby nominate this property to the National Register, certifying that the State Liaison Officer has been allowed 90 days in which to present the nomination to the State Review Board and to evaluate its significance. The recommended level of significance is <input type="checkbox"/> National <input type="checkbox"/> State <input checked="" type="checkbox"/> Local</p> <p>_____ Federal Representative Signature Date 5/8/74</p> <p>Paul O. Shelton Title: REGIONAL DIRECTOR</p>	<p>NATIONAL REGISTER VERIFICATION</p> <p>I hereby certify that this property is included in the National Register.</p> <p>_____ Director, Office of Archeology and Historic Preservation</p> <p>Date 10/9/74</p> <p>ATTEST:</p> <p>_____ Keeper of The National Register</p> <p>Date 10.7.74</p>
---	---

NATIONAL REGISTER OF HISTORIC PLACES
INVENTORY - NOMINATION FORM

(Continuation Sheet)

STATE		TEXAS	
COUNTY		CULBERSON	
FOR NPS USE ONLY			
ENTRY NUMBER		DATE	
OCT 9		1974	

(Number all entries)

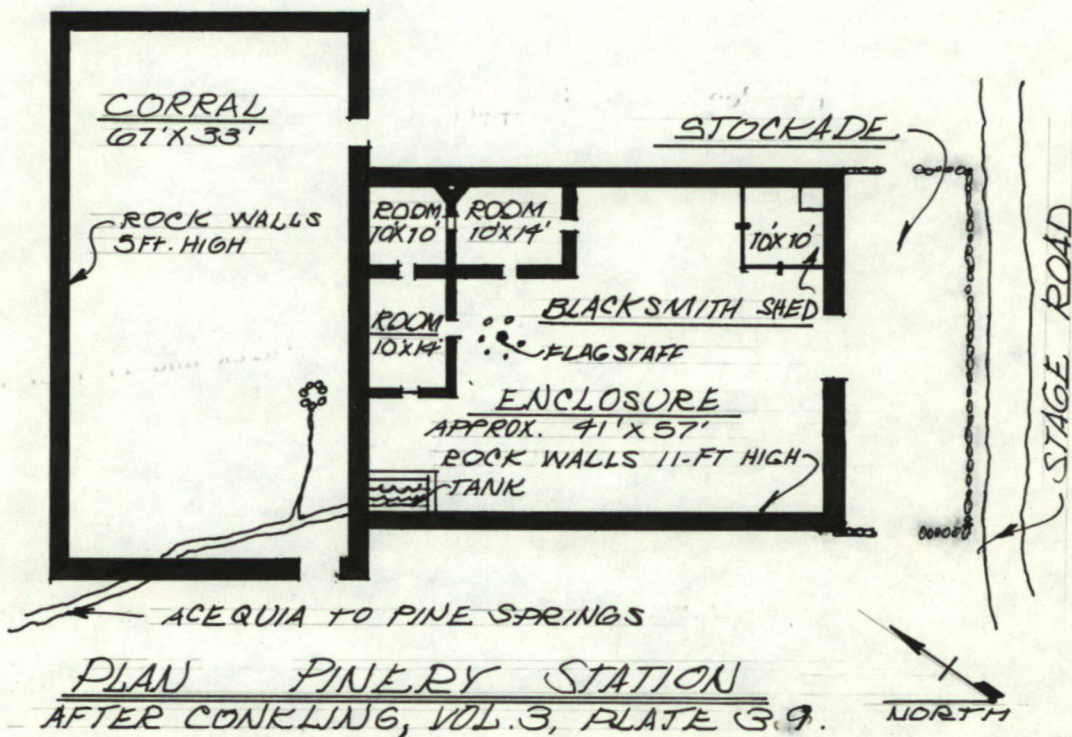

The attached National Register Inventory-Nomination form is being returned to your office for clarification of the information indicated below.

- 1. Name. Would prefer name as Pinery - Butterfield Stage Station; also need identifying number of structure. - No number assigned
- 2. Location. Code.
- 3. Classification. _____
- 4. Owner of Property. Code.
- 5. Location of Legal Description. Please give us location of legal description & code.
- 6. Representation in Existing Surveys. _____
- 7. Description. (a) Need recommended level of treatment proposed; and (b) need preliminary cost estimate for carrying out the proposed level of treatment.
- 8. Statement of Significance. _____
- 9. Bibliography. _____
- 10. Geographical Data.
 - a. Longitude and Latitude Coordinates: _____
 - b. Acreage. _____
- 11. Form Prepared By. Code.
- 12. Certification. Give title & date of signature.
- Photographic Coverage. We need black & white photos (cannot use color) - see Manual "How to Complete National Register Forms"; also need black & white photos not larger than 4 x 5 for the LCS.
- Map Coverage. _____
- Other. Please use 10-306 Forms filled out according to "How to Complete NR Forms."

Clarification or correction of the above items must be made prior to the initiation of our professional review. Correction of these technical errors does not necessarily insure that the nomination will then satisfy National Register criteria in full.

Thank you for your attention to the above items checked.

SIGNED: 
C. O. Meek

ROUTING AND REVIEW SLIP

THE ENCLOSED NOMINATIONS ARE ROUTED TO YOU FOR YOUR PROFESSIONAL REVIEW AND COMMENT ON THE CORRECTNESS AND ADEQUACY OF THE STATEMENTS AND EVALUATIONS CONTAINED THEREIN, SUPPLYING ADDITIONAL OR CORRECTIVE INFORMATION AS APPROPRIATE. REVIEWER WILL SIGN HIS NAME HEREON FOR LATER REFERENCE IF NECESSARY. USE ADDITIONAL SHEET FOR COMMENT IF NEEDED AND ATTACH HERETO.

NOMINATED PROPERTY: PINERY

FROM AREA OF: Guadalupe Mtns NP

3 PA

CHIEF ARCHEOLOGIST: *Looks like a good one.*

SIGNED: *Jackson W. Moore, Jr.*

2 PH

CHIEF HISTORIAN: *No comment*

SIGNED: *Henry G. Jones*

1 PC

CHIEF HISTORICAL ARCHITECT: *OK*

SIGNED: *N. A. Juedel*

4 PC

REGISTRAR, LCS

5 PR

KEEPER OF THE NATIONAL REGISTER:

- RECOMMENDED FOR THE NATIONAL REGISTER
- ENTERED ON THE LCS *May 19 74*

INT: 4937-74 REGISTRAR, LCS *[Signature]*

C. O. Meek
Registrar, LCS
Tel: 343-2532

PLEASE RETURN TO REGISTRAR, LCS BY

MAY 28 1974

Pinery Station - Texas

74000281

WORKING NUMBER

5.28.74. 875

TECH REVIEW

Photos 2

Maps 1

CONTROL REVIEW

am
5.30
74

OK

HISTORIAN

ARCHITECTURAL HISTORIAN

Accept
JC Thorman
7/24/74

ARCHEOLOGIST

*Site with a known tight dating
occupation should produce
interesting material.*

Accept
M. BARNES
8 Jul 74

REVIEW UNIT CHIEF

Accept
Cole
9/12/74

BRANCH CHIEF

KEEPER

Accept
Hunt
for Muntogh
10.7.74

National Register write-up Nov 21, 1974

Send-back _____

Federal Register entry 12/3/74

Re-submit _____

Entered

OCT 9 1974



UNITED STATES DEPARTMENT OF THE INTERIOR
NATIONAL PARK SERVICE

NATIONAL REGISTER OF HISTORIC PLACES
PROPERTY PHOTOGRAPH FORM

(Type all entries - attach to or enclose with photograph)

STATE	
TEXAS	
COUNTY	
CULBERSON	
FOR NPS USE ONLY	
ENTRY NUMBER	DATE
OCT 9 1974	

SEE INSTRUCTIONS

1. NAME

COMMON: BUTTERFIELD STAGE STATION
AND/OR HISTORIC: PINERY

2. LOCATION

STREET AND NUMBER:
(See Continuation Sheet)
CITY OR TOWN:
Guadalupe Mountains National Park

STATE:
Texas

CODE
48

COUNTY:
Culberson

CODE
109

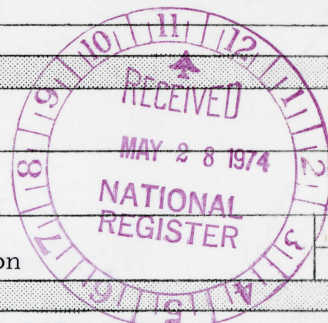

3. PHOTO REFERENCE

PHOTO CREDIT: Conkling, The Butterfield Overland Mail, 1851-1869, Vol. 3, Pl. 38.
DATE OF PHOTO: Copied, 5/19/72

NEGATIVE FILED AT:
National Park Service, Southwest Regional Office, Santa Fe, New Mexico

4. IDENTIFICATION

DESCRIBE VIEW, DIRECTION, ETC.

The "Pinery" as it appeared in 1858.

PROPERTY OF THE NATIONAL REGISTER

1 of 2



UNITED STATES DEPARTMENT OF THE INTERIOR
NATIONAL PARK SERVICE

NATIONAL REGISTER OF HISTORIC PLACES
PROPERTY PHOTOGRAPH FORM

(Type all entries - attach to or enclose with photograph)

STATE Texas	
COUNTY Culberson	
FOR NPS USE ONLY	
ENTRY NUMBER OCT 9 1974	DATE

SEE INSTRUCTIONS

1. NAME			
COMMON: Butterfield Stage Station			
AND/OR HISTORIC: Pinery			
2. LOCATION			
STREET AND NUMBER: (See continuation sheet)			
CITY OR TOWN: Guadalupe Mountain National Park			
STATE: Texas	CODE 48	COUNTY: Culberson	CODE 109
3. PHOTO REFERENCE			
PHOTO CREDIT: Richard W. Sellars			
DATE OF PHOTO: November 27, 1973			
NEGATIVE FILED AT: National Park Service, Southwest Regional Office, Santa Fe, New Mexico			
4. IDENTIFICATION			
DESCRIBE VIEW, DIRECTION, ETC. Northwest wall of enclosure; corral located to left of wall			

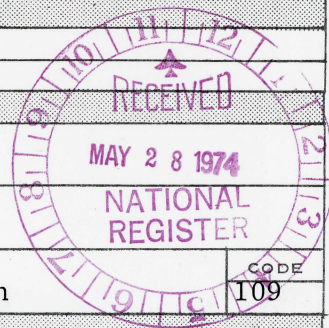

PROPERTY OF THE NATIONAL REGISTER

#2

NATIONAL REGISTER OF HISTORIC PLACES
PROPERTY MAP FORM

(Type all entries - attach to or enclose with map)

STATE TEXAS	
COUNTY CULBERSON	
FOR NPS USE ONLY	
ENTRY NUMBER OCT 9 1974	DATE

SEE INSTRUCTIONS

1. NAME			
COMMON: BUTTERFIELD STAGE STATION			
AND/OR HISTORIC: PINERY			
2. LOCATION			
STREET AND NUMBER: (See Continuation Sheet)			
CITY OR TOWN: Guadalupe Mountain National Park			
STATE: Texas	CODE 48	COUNTY: Culberson	CODE 109
3. MAP REFERENCE			
SOURCE: U.S.G.S. 15' Quadrangle "Guadalupe Peak, Texas"			
SCALE: 1:62,500			
DATE: 1933			
4. REQUIREMENTS			
TO BE INCLUDED ON ALL MAPS			
1. Property boundaries where required.			
2. North arrow.			
3. Latitude and longitude reference.			

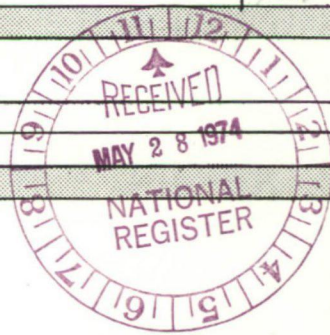

UNITED STATES
DEPARTMENT OF THE INTERIOR
GEOLOGICAL SURVEY

(El Paso Gap)

TEXAS

GUADALUPE PEAK QUADRANGLE

(Carlsbad Covers West)

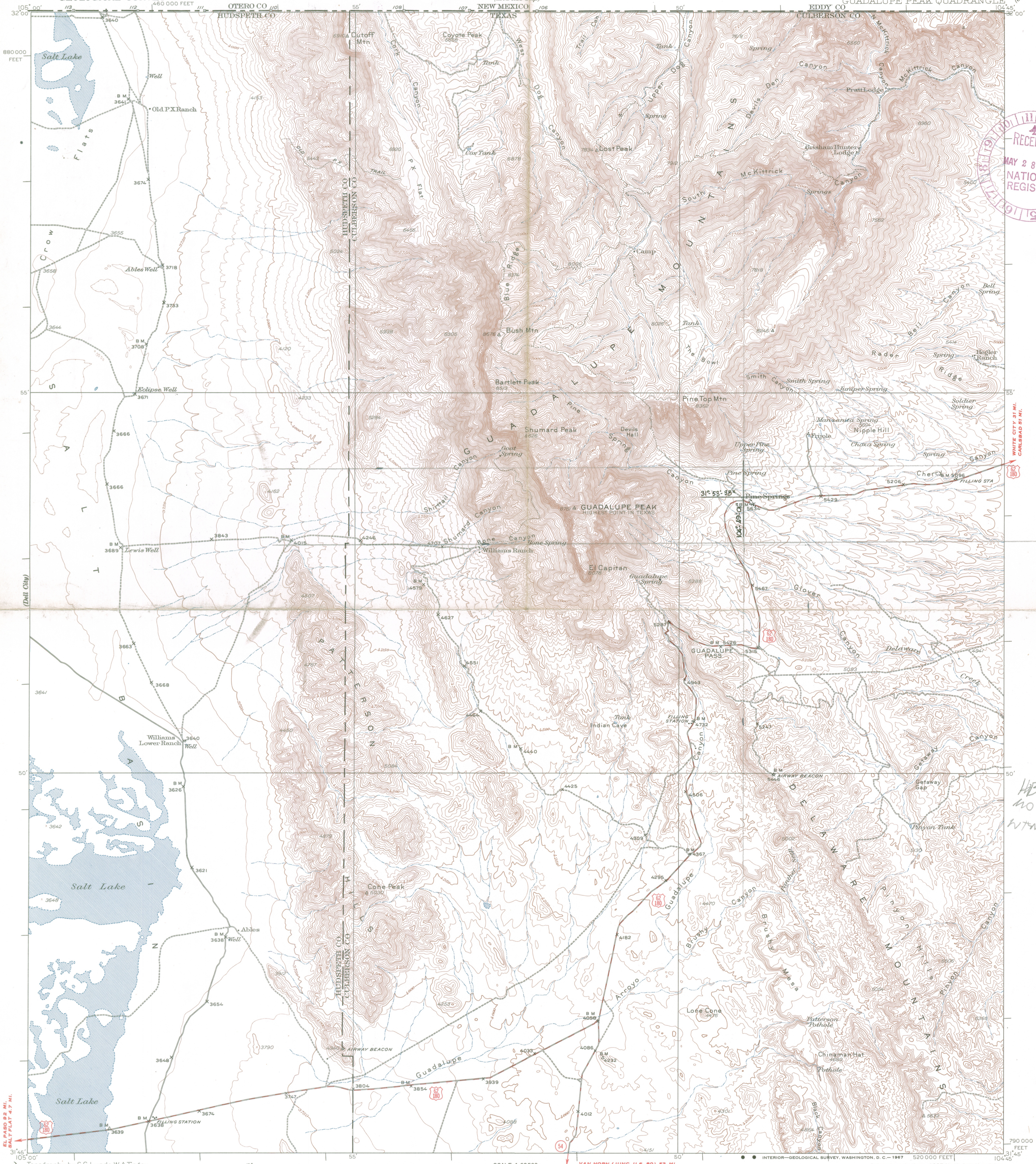

WHITE CITY 31 MI.
CARLSBAD 51 MI.

HAB
NO
WITH

EL PASO 8.5 MI.
SALT FLAT 8.7 MI.

Topography by S.G. Lunde, W.A. Tingey,
R.O. Davis, and J.M. Holmes
Surveyed in 1933

ROAD CLASSIFICATION
 HARD SURFACE ALL WEATHER ROADS
 Heavy-duty ——— 4 LANE LANE Improved dirt
 Medium-duty ——— 4 LANE LANE Unimproved dirt
 Loose-surface, graded, or narrow hard-surface — — — —
 U. S. Route State Route

APPROXIMATE MEAN
DECLINATION, 1933

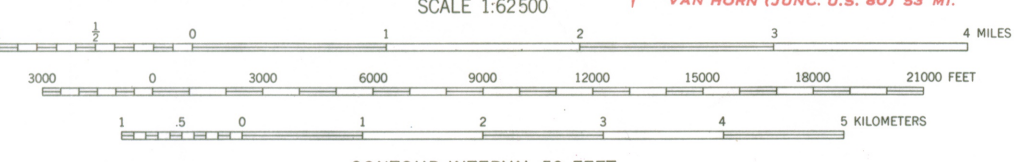

CONTOUR INTERVAL 50 FEET
DATUM IS MEAN SEA LEVEL

● INTERIOR—GEOLOGICAL SURVEY, WASHINGTON, D. C.—1967 520 000 FEET
 Since the publication of this map, the Texas (Central) rectangular coordinate system has been changed.
 Polyconic projection. 1927 North American datum
 10,000-foot grid based on Texas (Central) rectangular coordinate system

GUADALUPE PEAK, TEX.
N3145—W10445/15

1933

THIS MAP AVAILABLE WITH OR WITHOUT SHADED RELIEF OVERPRINT
 FOR SALE BY U. S. GEOLOGICAL SURVEY, DENVER, COLORADO 80225 OR WASHINGTON, D. C. 20242
 A FOLDER DESCRIBING TOPOGRAPHIC MAPS AND SYMBOLS IS AVAILABLE ON REQUEST

ENTRIES IN THE NATIONAL REGISTER

STATE **TEXAS**

Date Entered **OCT 9 1974**

<u>Name</u>	<u>Location</u>
Pinery Station	Guadalupe Mountain National Park Culberson County
Cuero I Archeological District	Cuero and Gonzales DeWitt and Gonzales Counties

Also Notified

Hon. John G. Tower
Hon. Lloyd M. Bentsen
Hon. Richard C. White
Hon. Abraham Kazen, Jr.
Mr. Douglas Wheeler, Deputy Assistant
Secretary for Fish and Wildlife & Parks
Mr. Robert M. Utley, Assistant Director,
Park Historic Preservation

State Historic Preservation Officer
Mr. Truett Latimer
Executive Director
Texas State Historical Survey
Committee
Post Office Box 12276
Capitol Station
Austin, Texas 78711

Regional Director, Southwest Region