

DATA SHEET

Form 10-306
(Oct. 1972)

UNITED STATES DEPARTMENT OF THE INTERIOR
NATIONAL PARK SERVICE

NATIONAL REGISTER OF HISTORIC PLACES INVENTORY - NOMINATION FORM FOR FEDERAL PROPERTIES

(Type all entries - complete applicable sections)

STATE:	TEXAS
COUNTY:	CULBERSON
FOR NPS USE ONLY	
ENTRY DATE	MAR 26 1975

1. NAME

* COMMON: WALLACE PRATT LODGE

AND/OR HISTORIC:
WALLACE PRATT LODGE

2. LOCATION

STREET AND NUMBER: *at jct of N and S branch of McKittrick Canyon*
(See Continuation Sheet)

CITY OR TOWN: Guadalupe Mountain National Park CONGRESSIONAL DISTRICT: 16th District - Texas

STATE: Texas CODE: 48 COUNTY: Culberson CODE: 109

3. CLASSIFICATION

CATEGORY (Check One)	OWNERSHIP	STATUS	ACCESSIBLE TO THE PUBLIC
<input type="checkbox"/> District <input type="checkbox"/> Building <input checked="" type="checkbox"/> Site <input type="checkbox"/> Structure <input type="checkbox"/> Object	<input checked="" type="checkbox"/> Public <input type="checkbox"/> Private <input type="checkbox"/> Both	Public Acquisition: <input type="checkbox"/> In Process <input type="checkbox"/> Being Considered	<input type="checkbox"/> Occupied <input checked="" type="checkbox"/> Unoccupied <input type="checkbox"/> Preservation work in progress
PRESENT USE (Check One or More as Appropriate)			
<input type="checkbox"/> Agricultural <input type="checkbox"/> Commercial <input type="checkbox"/> Educational <input type="checkbox"/> Entertainment	<input type="checkbox"/> Government <input type="checkbox"/> Industrial <input type="checkbox"/> Military <input type="checkbox"/> Museum	<input checked="" type="checkbox"/> Park <input type="checkbox"/> Private Residence <input type="checkbox"/> Religious <input type="checkbox"/> Scientific	<input type="checkbox"/> Transportation <input type="checkbox"/> Other (Specify) _____ <input type="checkbox"/> Comments _____ _____ _____

4. AGENCY

U. S. Government, National Park Service, Department of the Interior

REGIONAL HEADQUARTERS: (If applicable)
Southwest Regional Office

CITY OR TOWN: Santa Fe,

STREET AND NUMBER: P. O. Box 728

STATE: New Mexico CODE: 35

5. LOCATION OF LEGAL DESCRIPTION

COURTHOUSE, REGISTRY OF DEEDS, ETC.:
Culberson County Courthouse

STREET AND NUMBER:

CITY OR TOWN: Van Horn STATE: Texas CODE: 48

6. REPRESENTATION IN EXISTING SURVEYS

TITLE OF SURVEY: None

DATE OF SURVEY: Federal State County Local

DEPOSITORY FOR SURVEY RECORDS:

STREET AND NUMBER:

CITY OR TOWN: STATE: CODE:

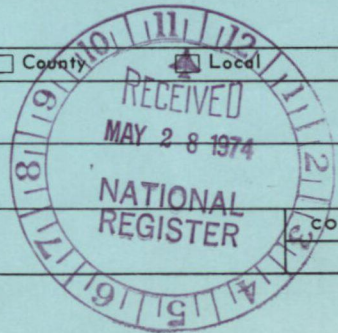

STATE:	Texas
COUNTY:	Culberson
ENTRY NUMBER	MAR 26 1975
DATE	

SEE INSTRUCTIONS

FOR NPS USE ONLY

7. DESCRIPTION

CONDITION	(Check One)					
	<input checked="" type="checkbox"/> Excellent	<input type="checkbox"/> Good	<input type="checkbox"/> Fair	<input type="checkbox"/> Deteriorated	<input type="checkbox"/> Ruins	<input type="checkbox"/> Unexposed
	(Check One)			(Check One)		
	<input type="checkbox"/> Altered	<input checked="" type="checkbox"/> Unaltered	<input type="checkbox"/> Moved	<input checked="" type="checkbox"/> Original Site		

DESCRIBE THE PRESENT AND ORIGINAL (if known) PHYSICAL APPEARANCE

The Pratt Lodge remains in virtually its original condition and appearance, with the exception that prohibition of vehicular traffic and disuse of the structures is resulting in erosion of the roads and some reclaiming of the immediate grounds by an overgrowth of natural vegetation.

The lodge complex consists of three buildings: the main house, a garage, and a pumphouse. The house contains two bedrooms, two baths, a living room, and a kitchen. The garage has, in addition to a double-car stall, what was apparently a caretaker's quarters, consisting of a kitchen-living area and a bathroom. In addition, there is an extensive system of stone fences bordering the site to the south and west.

The buildings are all one-story structures of native stone. The walls are generally of ashlar construction, approximately one-foot thick. The floors and fences are of native flagstone. The gabled roofs are of heavy timber construction, and are also roofed with flagstone. Wood double-hung windows were used throughout.

Recommended treatment: Preservation

Estimated Cost: \$5,000 initially, \$750 P/A thereafter based on 1973 costs.



SEE INSTRUCTIONS

8. SIGNIFICANCE

PERIOD (Check One or More as Appropriate)

- | | | | |
|----------------------------------------|---------------------------------------|---------------------------------------|--------------------------------------------------|
| <input type="checkbox"/> Pre-Columbian | <input type="checkbox"/> 16th Century | <input type="checkbox"/> 18th Century | <input checked="" type="checkbox"/> 20th Century |
| <input type="checkbox"/> 15th Century | <input type="checkbox"/> 17th Century | <input type="checkbox"/> 19th Century | |

SPECIFIC DATE(S) (If Applicable and Known) 1930

AREAS OF SIGNIFICANCE (Check One or More as Appropriate)

- | | | | |
|--------------------------------------------------|---------------------------------------|----------------------------------------------|------------------------------------------|
| <input type="checkbox"/> Aboriginal | <input type="checkbox"/> Education | <input type="checkbox"/> Political | <input type="checkbox"/> Urban Planning |
| <input type="checkbox"/> Prehistoric | <input type="checkbox"/> Engineering | <input type="checkbox"/> Religion/Philosophy | <input type="checkbox"/> Other (Specify) |
| <input type="checkbox"/> Historic | <input type="checkbox"/> Industry | | _____ |
| <input type="checkbox"/> Agriculture | <input type="checkbox"/> Invention | <input type="checkbox"/> Science | _____ |
| <input checked="" type="checkbox"/> Architecture | <input type="checkbox"/> Landscape | <input type="checkbox"/> Sculpture | _____ |
| <input type="checkbox"/> Art | <input type="checkbox"/> Architecture | <input type="checkbox"/> Social/Humanitarian | _____ |
| <input type="checkbox"/> Commerce | <input type="checkbox"/> Literature | <input type="checkbox"/> Theater | _____ |
| <input type="checkbox"/> Communications | <input type="checkbox"/> Military | <input type="checkbox"/> Transportation | _____ |
| <input checked="" type="checkbox"/> Conservation | <input type="checkbox"/> Music | | _____ |

STATEMENT OF SIGNIFICANCE

Wallace E. Pratt, a world-renowned geologist who pioneered the techniques of scientific oil exploration, began construction of a summer place at this site in 1930. As a geologist he recognized the scientific value of the Capitan Barrier Fossil Reef, but purchased the McKittrick Canyon property for its aesthetic qualities, stating that natural beauty in itself is a resource to be valued. An avid conservationist, he was a vigorous proponent of techniques designed to conserve oil and gas resources, and when he began ranching the McKittrick Canyon property upon his retirement from the business world he exhibited no less concern for the ecology of the area. A pioneer in the field of ecological concern, he was 20 years ahead of his time. When health forced his departure from McKittrick Canyon, his concern that the area be preserved in its natural state prompted his donation of the initial 5,632 acres which formed the nucleus of what was to become Guadalupe Mountain National Park.

The architecture of the structures reflects Mr. Pratt's philosophies. Of simple design and pleasing proportions, the structure is constructed almost entirely of native stone. The indigenous character of the structures harmonize beautifully with the setting and they are therefore worthy of preservation on the basis of their architectural merit alone, to say nothing of the significance of their association with Mr. Pratt.

SEE INSTRUCTIONS

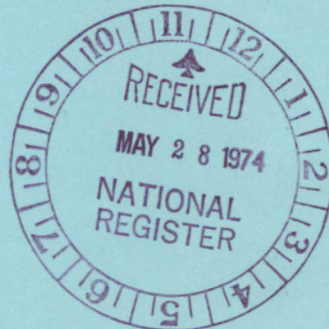

9. MAJOR BIBLIOGRAPHICAL REFERENCES

Cheatham, Edgar and Patricia. "The Extraordinary World of Wallace E. Pratt." Petroleum Today, Summer 1971, Vol. 12, No. 2, pp 1-5.

Copithorne, W. L. "The Worlds of Wallace Pratt." The Lamp, Fall 1971, Vol. 53, No. 3, pp 10-15.

Elliot, Keith. "The Treasure of the Guadalupe." The Humble Way, Third Quarter 1970, Vol. IX, No. 3, pp 3-7.

10. GEOGRAPHICAL DATA

LATITUDE AND LONGITUDE COORDINATES DEFINING A RECTANGLE LOCATING THE PROPERTY			O R	LATITUDE AND LONGITUDE COORDINATES DEFINING THE CENTER POINT OF A PROPERTY OF LESS THAN TEN ACRES		
CORNER	LATITUDE	LONGITUDE		LATITUDE	LONGITUDE	
	Degrees Minutes Seconds	Degrees Minutes Seconds		Degrees Minutes Seconds	Degrees Minutes Seconds	
NW	0	0		31° 59' 01"	104° 46' 50"	
NE	0	0				
SE	0	0				
SW	0	0				

NO
LTM
CD

APPROXIMATE ACREAGE OF NOMINATED PROPERTY: 4

LIST ALL STATES AND COUNTIES FOR PROPERTIES OVERLAPPING STATE OR COUNTY BOUNDARIES

STATE:	CODE	COUNTY:	CODE

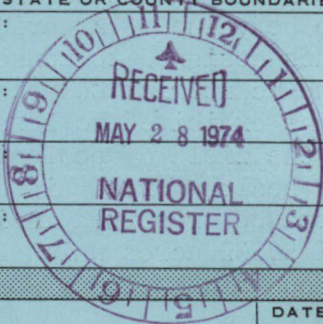

SEE INSTRUCTIONS

11. FORM PREPARED BY

NAME AND TITLE: David G. Battle, Historical Architect DATE: February 1974

BUSINESS ADDRESS: National Park Service, Southwest Regional

STREET AND NUMBER: P. O. Box 728 PHONE: (505) 988-6501

CITY OR TOWN: Santa Fe, New Mexico STATE: New Mexico CODE: 35

12. CERTIFICATION OF NOMINATION

State Liaison Officer recommendation:

Yes
 No
 None

Quell Salinas
 State Liaison Officer Signature

In compliance with Executive Order 11593, I hereby nominate this property to the National Register, certifying that the State Liaison Officer has been allowed 90 days in which to present the nomination to the State Review Board and to evaluate its significance. The recommended level of significance is Local National State

Walter Wheeler MAR 18 1975
 Federal Representative Signature Date

Deputy Assistant Secretary
 Title

NATIONAL REGISTER VERIFICATION

I hereby certify that this property is included in the National Register.

AR Moutoussien
 Director, Office of Archeology and Historic Preservation

Date 3/26/75

ATTEST:

W.D. Smutz
 Keeper of The National Register

Date 3.5.75

NATIONAL REGISTER OF HISTORIC PLACES
INVENTORY - NOMINATION FORM

(Continuation Sheet)

STATE	
TEXAS	
COUNTY	
CULBERSON	
FOR NPS USE ONLY	
ENTRY NUMBER	DATE
	MAR 26 1975

(Number all entries)

2. LOCATION

The Pratt Lodge is located at the juncture of the north and south branches of McKittrick Canyon. The mouth of the canyon is accessible by automobile only by obtaining the necessary keys from the National Park Service. From the mouth of the canyon, access may be gained only by foot over a trail along the floor of the canyon, a distance of approximately 2.5 miles.

9. MAJOR BIBLIOGRAPHICAL REFERENCES

Parent, Annette R. "The Southwest's Newest National Park." Pacific Discovery, March/April 1970, Vol. XXIII, No. 2, pp 12-19.



The attached National Register Inventory-Nomination form is being returned to your office for clarification of the information indicated below.

- 1. Name. need identifying number of structure (No number)
- 2. Location. Code
- 3. Classification. _____
- 4. Owner of Property. Code
- 5. Location of Legal Description. give location of legal description & code
- 6. Representation in Existing Surveys. _____
- 7. Description. (a) Need recommended level of treatment proposed; and (b) need preliminary cost estimate for carrying out the proposed level of treatment
- 8. Statement of Significance. _____
- 9. Bibliography. _____
- 10. Geographical Data.
 - a. Longitude and Latitude Coordinates. _____
 - b. Acreage. _____
- 11. Form Prepared By. Code
- 12. Certification. _____
- Photographic Coverage. need black & white photos - not color - see "How to Complete NR Forms"; also need black & white photos not larger than 4 X 5 for the LCS
- Map Coverage. _____
- Other. _____

Clarification or correction of the above items must be made prior to the initiation of our professional review. Correction of these technical errors does not necessarily insure that the nomination will then satisfy National Register criteria in full.

Thank you for your attention to the above items checked.

SIGNED: 
C. O. Meek

ROUTING AND REVIEW SLIP

THE ENCLOSED NOMINATIONS ARE ROUTED TO YOU FOR YOUR PROFESSIONAL REVIEW AND COMMENT ON THE CORRECTNESS AND ADEQUACY OF THE STATEMENTS AND EVALUATIONS CONTAINED THEREIN, SUPPLYING ADDITIONAL OR CORRECTIVE INFORMATION AS APPROPRIATE. REVIEWER WILL SIGN HIS NAME HEREON FOR LATER REFERENCE IF NECESSARY. USE ADDITIONAL SHEET FOR COMMENT IF NEEDED AND ATTACH HERETO.

NOMINATED PROPERTY: WALLACE PRATT LODGE

FROM AREA OF: Guadalupe Mtns NP

~~3~~ PA

CHIEF ARCHEOLOGIST: *This one stands out, favorably.*

SIGNED: *Jackson W. Moore, Jr.*

~~4~~ RH

CHIEF HISTORIAN: *No comment.*

SIGNED: *Henry W. Boy*

~~5~~ RC

CHIEF HISTORICAL ARCHITECT: *OK*

SIGNED: *W. A. Judet*

~~6~~ PC

REGISTRAR, LCS

5 PR

KEEPER OF THE NATIONAL REGISTER:

- RECOMMENDED FOR THE NATIONAL REGISTER
- ENTERED ON THE LCS *May 19 74*

INT: *[Signature]* REGISTRAR LCS

C. O. Meek
Registrar, LCS
Tel: 343-2532

PLEASE RETURN TO REGISTRAR, LCS BY

MAY 28 1974

Pratt, Wallace, Lodge

Defas

WORKING NUMBER

5.28.74.876

75000154

TECH REVIEW

Photos

4

Maps

2

CONTROL REVIEW

cm

5.30

74

HISTORIAN

Agree - ^{Nice!} not not enough for 50yr limit
w. R. Luce
7/25/74
OK

ARCHITECTURAL HISTORIAN

I do not feel this merits ~~exemption~~ ^{exemption} from the 50 yr. limit. Why a site instead of bldg.?
Return letter
JCT
7/22/74

ARCHEOLOGIST

Significance appears to be good, but 50 year rule may exclude.

Conference
M. BARNES
17 July 74

REVIEW UNIT CHIEF

Conference

BRANCH CHIEF

KEEPER

National Register write-up

Send-back

10.24.74

Federal Register entry

5-6-75

Re-submit

12.31.74

Entered

MAR 26 1975

NAME OF PROPERTY Wallace Pratt Lodge Homer Wilson Ranch STATE Texas

The attached National Register Inventory-Nomination form is being returned to your office for clarification of the information indicated below. PLEASE RETURN THIS FORM WHEN THE NOMINATION IS RESUBMITTED.

7 Description: _____

8 Statement of Significance: _____

9 Bibliography: _____

10 Geographical Data -- Acreage: _____
UTM Reference(s): _____
Verbal Boundary Description: _____

12 Certification: Please have Federal repres. sign nomination

Photographic Coverage: _____

Map Coverage: _____

Other: _____

Questions concerning this nomination may be directed to _____

on the National Register staff, telephone _____

Thank you for your attention to the above items.

Charles Atkins
Chief, Branch of Registration

Date: 3-14-75

INT:2105-74

Property Pratt, Wallace, Ledge

2nd Control Sheet

State Texas

Working Number 5.28.74.876

73000 154

TECHNICAL

Photos 4
Maps 2

They pasted another signature tag over Fred Rep signature

CONTROL
cm

otherwise OK 12.31.74

HISTORIAN

ARCHITECTURAL HISTORIAN

ARCHEOLOGIST

OTHER

HAER

Inventory _____

Review _____

REVIEW UNIT CHIEF

BRANCH CHIEF

*Conference
Accept*

[Signature]

2.6.75

KEEPER

I don't find this anything to write home about architecturally, but appears to be admirable on associative grounds.

*[Signature]
3/25/75*

National Register Write-up _____
Federal Register Entry 5-6-75

Send-back 3.14.75
Re-submit 3.19.75

Entered MAR 26 1975

INT:2106-74



UNITED STATES DEPARTMENT OF THE INTERIOR
NATIONAL PARK SERVICE

NATIONAL REGISTER OF HISTORIC PLACES
PROPERTY PHOTOGRAPH FORM

(Type all entries - attach to or enclose with photograph)

STATE TEXAS	
COUNTY CULBERSON	
FOR NPS USE ONLY	
ENTRY NUMBER	DATE
	MAR 26 1975

SEE INSTRUCTIONS

1. NAME			
COMMON:			
AND/OR HISTORIC: WALLACE PRATT LODGE			
2. LOCATION			
STREET AND NUMBER: (See Continuation Sheet)			
CITY OR TOWN: Guadalupe Mountains National Park			
STATE: Texas	CODE 48	COUNTY: Culberson	CODE 109
3. PHOTO REFERENCE			
PHOTO CREDIT: David G. Battle			
DATE OF PHOTO: 5/17/72			
NEGATIVE FILED AT: National Park Service, Southwest Regional Office, Santa Fe, New Mexico			
4. IDENTIFICATION			
DESCRIBE VIEW, DIRECTION, ETC. House, East Side			

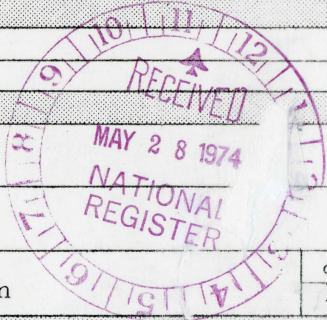

PROPERTY OF THE NATIONAL REGISTER

1064



UNITED STATES DEPARTMENT OF THE INTERIOR
NATIONAL PARK SERVICE

NATIONAL REGISTER OF HISTORIC PLACES
PROPERTY PHOTOGRAPH FORM

(Type all entries - attach to or enclose with photograph)

STATE TEXAS	
COUNTY CULBERSON	
FOR NPS USE ONLY	
ENTRY NUMBER	DATE
	MAR 26 1975

SEE INSTRUCTIONS

1. NAME			
COMMON:			
AND/OR HISTORIC: WALLACE PRATT LODGE			
2. LOCATION			
STREET AND NUMBER: (See Continuation Sheet)			
CITY OR TOWN: Guadalupe Mountains National Park			
STATE: Texas	CODE 48	COUNTY: Culberson	CODE 109
3. PHOTO REFERENCE			
PHOTO CREDIT: David G. Battle			
DATE OF PHOTO: 5/17/72			
NEGATIVE FILED AT: National Park Service, Southwest Regional Office, Santa Fe, New Mexico			
4. IDENTIFICATION			
DESCRIBE VIEW, DIRECTION, ETC. House, West Side			

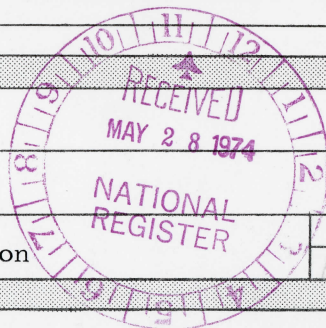

PROPERTY OF THE NATIONAL REGISTER

#294



UNITED STATES DEPARTMENT OF THE INTERIOR
NATIONAL PARK SERVICE

NATIONAL REGISTER OF HISTORIC PLACES
PROPERTY PHOTOGRAPH FORM

(Type all entries - attach to or enclose with photograph)

STATE	
TEXAS	
COUNTY	
CULBERSON	
FOR NPS USE ONLY	
ENTRY NUMBER	DATE
MAR 26 1975	

SEE INSTRUCTIONS

1. NAME

COMMON:
AND/OR HISTORIC: WALLACE PRATT LODGE

2. LOCATION

STREET AND NUMBER:
(See Continuation Sheet)

CITY OR TOWN:
Guadalupe Mountains National Park

STATE:	CODE	COUNTY:	CODE
Texas	48	Culberson	109

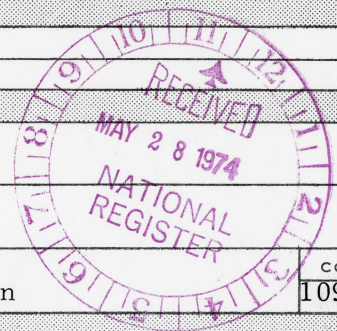

3. PHOTO REFERENCE

PHOTO CREDIT: David G. Battle

DATE OF PHOTO: 5/17/72

NEGATIVE FILED AT:
National Park Service, Southwest Regional Office, Santa Fe, New Mexico

4. IDENTIFICATION

DESCRIBE VIEW, DIRECTION, ETC.
Garage, West Side

3074

PROPERTY OF THE NATIONAL REGISTER



UNITED STATES DEPARTMENT OF THE INTERIOR
NATIONAL PARK SERVICE

NATIONAL REGISTER OF HISTORIC PLACES

PROPERTY PHOTOGRAPH FORM

(Type all entries - attach to or enclose with photograph)

STATE	
TEXAS	
COUNTY	
CULBERSON	
FOR NPS USE ONLY	
ENTRY NUMBER	DATE
WAR 26 1975	

SEE INSTRUCTIONS

1. NAME

COMMON:

AND/OR HISTORIC: WALLACE PRATT LODGE

2. LOCATION

STREET AND NUMBER:

(See Continuation Sheet)

CITY OR TOWN:

Guadalupe Mountains National Park

STATE:

Texas

CODE

48

COUNTY:

Culberson

CODE

109

3. PHOTO REFERENCE

PHOTO CREDIT: David G. Battle

DATE OF PHOTO: 5/17/72

NEGATIVE FILED AT:

National Park Service, Southwest Regional Office, Santa Fe, New Mexico

4. IDENTIFICATION

DESCRIBE VIEW, DIRECTION, ETC.

Pump House, South Side

#4 of 4

PROPERTY OF THE NATIONAL REGISTER

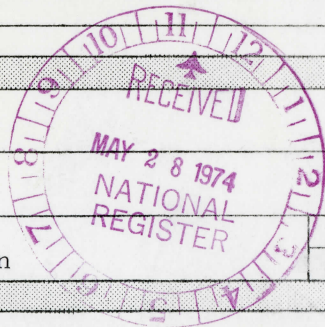

UNITED STATES
DEPARTMENT OF THE INTERIOR
GEOLOGICAL SURVEY

Piney Mountain
(Coalsbad Covers West)

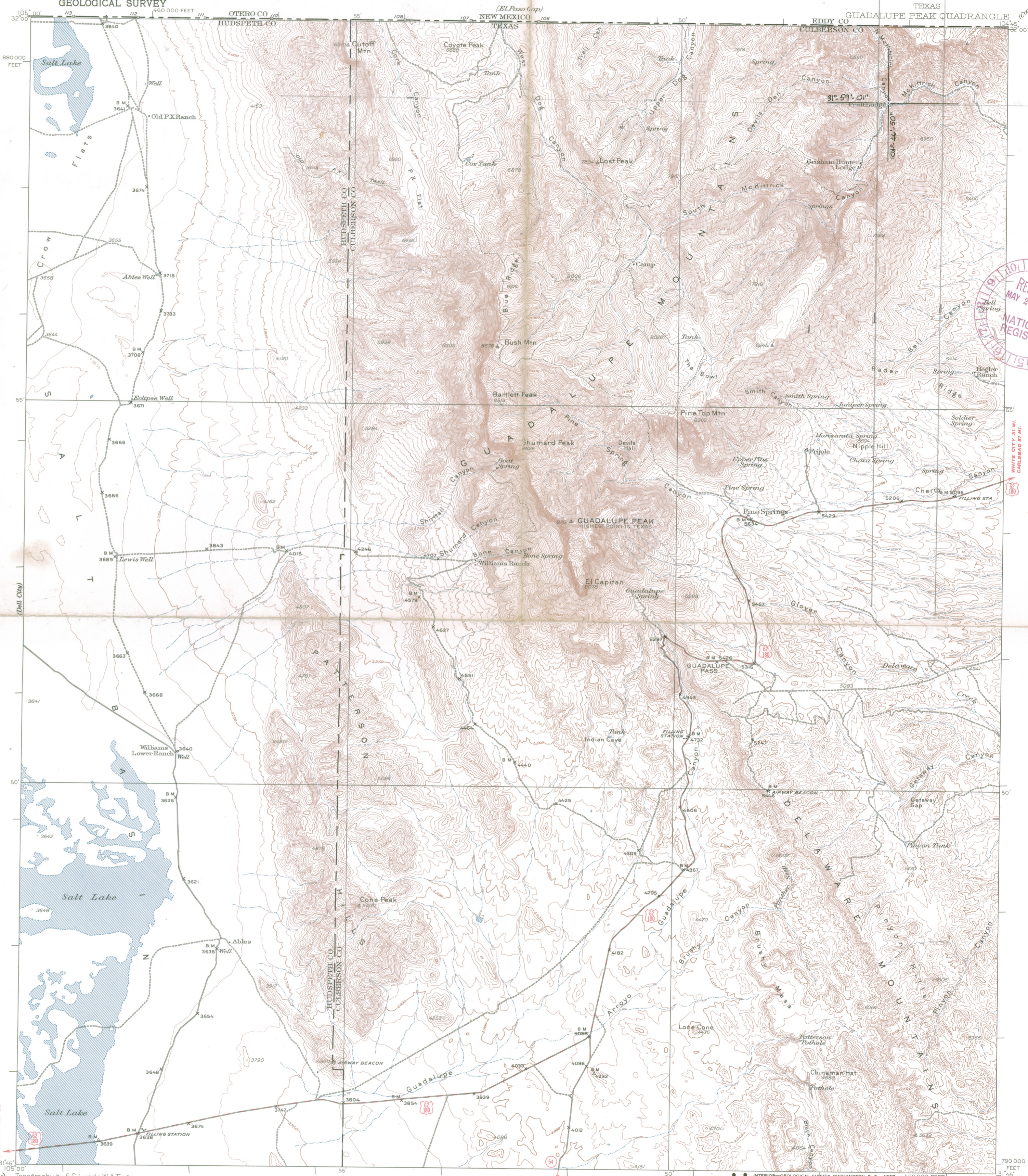

RECEIVED
MAY 28 1974
NATIONAL REGISTER

EL PASO 92 MI.
SALT FLAT 4.7 MI.

Topography by S.G. Lunde, W.A. Tingey,
R.O. Davis, and J.M. Holmes
Surveyed in 1933

ROAD CLASSIFICATION
 HARD-SURFACE ALL WEATHER ROADS DRY WEATHER ROADS
 Heavy-duty 4 LANE 8 LANE Improved dirt
 Medium-duty 4 LANE 8 LANE Unimproved dirt
 Loose-surface, graded, or narrow hard-surface
 U. S. Route State Route

TRUE NORTH
MAGNETIC NORTH
APPROXIMATE MEAN DECLINATION, 1933

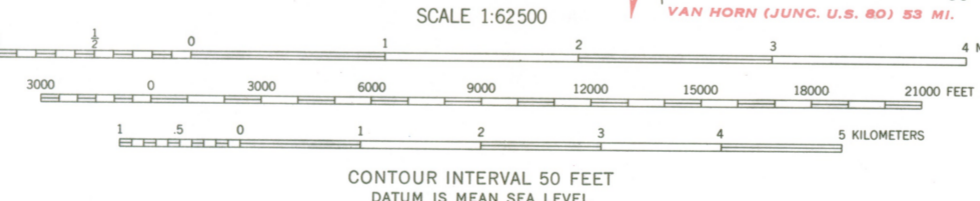

● INTERIOR—GEOLOGICAL SURVEY, WASHINGTON, D. C.—1967
 Since the publication of this map, the Texas (Central) rectangular coordinate system has been changed

Polyconic projection. 1927 North American datum
 10,000-foot grid based on Texas (Central) rectangular coordinate system

GUADALUPE PEAK, TEX.
N3145-W10445/15
1933

THIS MAP AVAILABLE WITH OR WITHOUT SHADED RELIEF OVERPRINT
 FOR SALE BY U. S. GEOLOGICAL SURVEY, DENVER, COLORADO 80225 OR WASHINGTON, D. C. 20242
 A FOLDER DESCRIBING TOPOGRAPHIC MAPS AND SYMBOLS IS AVAILABLE ON REQUEST

**NATIONAL REGISTER OF HISTORIC PLACES
PROPERTY MAP FORM**

(Type all entries - attach to or enclose with map)

STATE	
TEXAS	
COUNTY	
CULBERSON	
FOR NPS USE ONLY	
ENTRY NUMBER	DATE

SEE INSTRUCTIONS

1. NAME			
COMMON:			
AND/OR HISTORIC: WALLACE PRATT LODGE			
2. LOCATION			
STREET AND NUMBER:			
(See Continuation Sheet)			
CITY OR TOWN:			
Guadalupe Mountain National Park			
STATE:	CODE	COUNTY:	CODE
Texas	48	Culberson	109
3. MAP REFERENCE			
SOURCE:			
USGS 15' Quadrangle, "Guadalupe Peak, Texas"			
SCALE: 1:62,500			
DATE: 1933			
4. REQUIREMENTS			
TO BE INCLUDED ON ALL MAPS			
1. Property boundaries where required.			
2. North arrow.			
3. Latitude and longitude reference.			



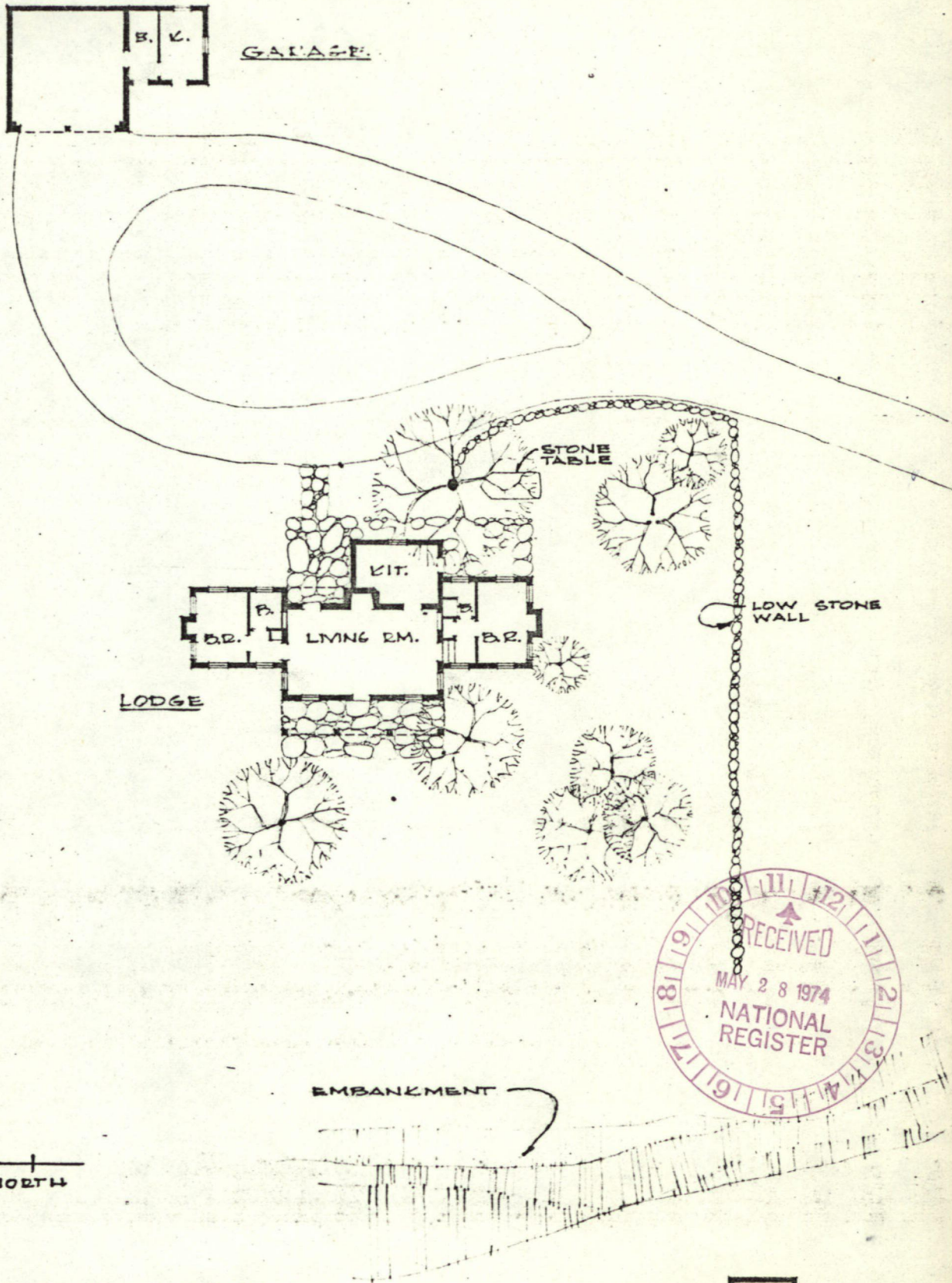

WALLACE PRATT LODGE.
 Mc KITTRICK CANYON
 GUADALUPE MOUNTAINS NATIONAL PARK

SCALE 1" = 10' 20' 30' 40' 50' FEET
 ALL DIMENSIONS ARE APPROXIMATE
 D.G.R. / 5-17-72

☐
 PUMPHOUSE

**NATIONAL REGISTER OF HISTORIC PLACES
PROPERTY MAP FORM**

(Type all entries - attach to or enclose with map)

STATE TEXAS	
COUNTY CULBERSON	
FOR NPS USE ONLY	
ENTRY NUMBER MAR 26 1975	DATE

SEE INSTRUCTIONS

1. NAME			
COMMON:			
AND/OR HISTORIC: WALLACE PRATT LODGE			
2. LOCATION			
STREET AND NUMBER: (See Continuation Sheet)			
CITY OR TOWN: Guadalupe Mountain National Park			
STATE: Texas	CODE 48	COUNTY: Culberson	CODE 109
3. MAP REFERENCE			
SOURCE: Site Plan Sketch, D. G. Battle, National Park Service, Southwest Regional Office, Santa Fe, New Mexico			
SCALE: 1" = 16' 0"			
DATE: 5/17/72			
4. REQUIREMENTS			
TO BE INCLUDED ON ALL MAPS			
1. Property boundaries where required.			
2. North arrow.			
3. Latitude and longitude reference.			



Cole
10/18/74
Mortensen
07/23

H34-PR

OCT 24 1974

Memorandum

To: Douglas P. Wheeler
Federal Representative for Executive Order 11593
Department of the Interior

From: A. R. Mortensen
Director, Office of Archeology and Historic Preservation

Subject: National Park Service Nominations for Listing the Wallace
Pratt Lodge and the Homer Wilson Ranch on the National
Register

We are returning the National Park Service nomination for the Wallace Pratt Lodge and the Homer Wilson Ranch. Although they include interesting structures of the 1930's, neither property appears to be of sufficient architectural or historic significance to merit an exception to the 50 year criteria of the National Register. If the National Park Service can supply additional information that demonstrates exceptional significance, we will be happy to review the nominations again.

(Sgd.) A. R. Mortensen

Enclosure

FNP:M Barnes:lm1:19/26/74
 Rewritten:10/9/74
 Rewritten:ARMortensen:lm1:10/17/74
 bcc: Director's Reading File
 DI
 PP
 PH
 PR -Mrs Mott w/cy inc.

BASIC FILE RETAINED IN PR



United States Department of the Interior

OFFICE OF THE SECRETARY
WASHINGTON, D.C. 20240

Memorandum

To: Director, Office of Archeology and Historic Preservation
National Park Service

From: Federal Representative to the National Register
Department of the Interior

Subject: National Park Service Nominations for Listing the Wallace
Pratt Lodge and the Homer Wilson Ranch on the National
Register

We have reexamined the above forms and are returning them to your office with the request that they be given further evaluation.

Although of rather recent construction we believe that these sites have significance within the local context and understand that the National Park Service proposes to preserve and exhibit them as such. If after reevaluation you continue to believe that the statements of significance are inadequate we shall return them to the National Park Service so that they might be strengthened.

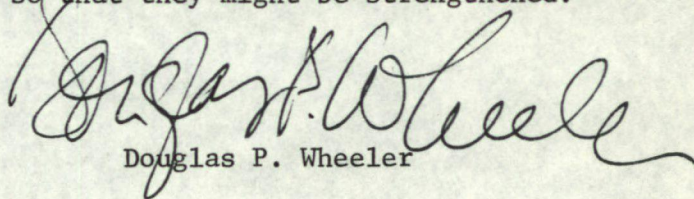
Douglas P. Wheeler

Enclosure





United States Department of the Interior

NATIONAL PARK SERVICE
WASHINGTON, D.C. 20240

IN REPLY REFER TO:

MAR 12 1975

Dear Federal Representative:

This National Register nomination is returned to you for technical or professional revision as requested on the enclosed sheet. During the period when you are completing the revisions necessary for re-submission to the National Register, the property will be protected by the provisions of Executive Order 11593, Section 2(b), as it is likely to meet the criteria for listing on the National Register. The name and address of the property will also appear in the "Federal Register" as a 2(b) determination until the formal nomination is approved, at which time it will appear in the "Federal Register" with the other entries.

Should any situation arise concerning Federal action which will affect this property, please consult the Advisory Council on Historic Preservation, 1522 K Street, N.W., Suite 430, Washington, D.C. 20005.

Sincerely yours,

William J. Murtagh
Keeper of the National Register



United States Department of the Interior

NATIONAL PARK SERVICE
WASHINGTON, D.C. 20240

IN REPLY REFER TO:

MAR 14 1975

Dear Federal Representative:

This National Register nomination is returned to you for technical or professional revision as requested on the enclosed sheet. During the period when you are completing the revisions necessary for re-submission to the National Register, the property will be protected by the provisions of Executive Order 11593, Section 2(b), as it is likely to meet the criteria for listing on the National Register. The name and address of the property will also appear in the "Federal Register" as a 2(b) determination until the formal nomination is approved, at which time it will appear in the "Federal Register" with the other entries.

Should any situation arise concerning Federal action which will affect this property, please consult the Advisory Council on Historic Preservation, 1522 K Street, N.W., Suite 430, Washington, D.C. 20005.

Sincerely yours,

William J. Murtagh
Keeper of the National Register

ENTRIES IN THE NATIONAL REGISTER

STATE TEXAS

Date Entered MAR 26 1975

<u>Name</u>	<u>Location</u>
Pratt, Wallace, Lodge	Guadalupe Mountain National Park Culberson County

Also Notified

Hon. John G. Tower	State Historic Preservation Officer
Hon. Lloyd M. Bentsen	Mr. Truett Latimer, Executive Director
Hon. Richard C. White	Texas State Historical Survey Committee
Mr. Robert Utley, Department of the Interior	Post Office Box 12276, Capitol Station Austin, Texas 78711
Mr. Douglas Wheeler, Department of the Interior	Regional Director, Southwest Region

PR

MMott/cha

3-28-75

MJR
HE

NR Data Sheet

DATE: Reviewer INITIALS:
NR DOE 3/26/75

NAME AS IT APPEARS IN FEDERAL REGISTER: Pratt, Wallace, Lodge

OTHER NAMES:

LOCATION:

STREET & NUMBER ^{set.} At junction of N and S branch of McKittrick Canyon
CITY, TOWN ^{set.} Guadalupe Mountain VICINITY OF
STATE National Park TX 048
CONGRESSIONAL DISTRICT 16
COUNTY Culberson code 109

OWNER OF PROPERTY: (Circle) PRIVATE STATE LOCAL GOV'T MUNICIPAL COUNTY OTHER

ADMINISTRATOR (underline)

FEDERAL (AGENCY NAME) National Park Service

NPS REGION: (CIRCLE) N. ATLANTIC MID ATLANTIC SOUTHEAST MIDWEST

SOUTHWEST ROCKY MOUNTAIN WEST PACIFIC NORTHWEST

FEATURES:

INTERIOR EXTERIOR ENVIRONS
Substantially intact-1 Substantially intact-2 Substantially intact-3
- unknown - 4 - unknown - 5 - unknown - 6
- not applicable - 7 - not applicable - 8 - Not applicable - 9

CONDITION - EXCELLENT DETERIORATED UNALTERED ORIGINAL SITE
GOOD RUINS ALTERED MOVED
FAIR UNEXPOSED Reconstructed Unknown
Unexcavated Excavated

ACCESS - Yes-restricted Yes-unrestricted No access Unknown

historic district? YES NO

WITHIN NATIONAL REGISTER HISTORIC DISTRICT? YES NO
IF YES, NAME:

WITHIN NATIONAL HISTORIC LANDMARK? YES NO
IF YES, NAME:

ADAPTIVE USE: YES NO Saved? YES NO

FUNCTION(S): (use vocabulary words)

then- House

now- Park

SIGNIFICANCE:

ARCHAEOLOGY-PREHISTORIC CONSERVATION LANDSCAPE ARCHITECTURE RELIGION entertainment
ARCHAEOLOGY-HISTORIC ECONOMICS LAW/Gov't/politics SCIENCE -23 health
AGRICULTURE EDUCATION LITERATURE recreation
ARCHITECTURE -4 MILITARY SOCIAL/HUMANITARIAN settlement
ART ENGINEERING MUSIC socio/cultural
COMMERCE EXPLORATION PHILOSOPHY TRANSPORTATION urban & commun
COMMUNICATIONS INDUSTRY POLITICS/GOVERNMENT OTHER (SPECIFY) planning
INVENTION

Claims

"first" YES NO "oldest" YES NO "only" YES NO

ARCHITECTURAL STYLE:

architect/m.builder:

landscape/garden designer:

interior decorator:

engineer:

artist/artisan:

builder/contractor:

ETHNIC GROUP:

NAMES:

(label role & appropriate date)

personal (1) Wallace E. Pratt - geologist - pioneered techniques of scientific oil exploration. events

institutional

DATES:

DATE OF CONSTRUCTION (Specific date or 1/4 of century): 1930

DATE(S) OF "MAJOR" ALTERATIONS:

HISTORICALLY SIGNIFICANT DATE(S):

SOURCE:

(OF NOMINATION) PRIVATE STATE LOCAL GOV'T MUNICIPAL COUNTY
OTHER FEDERAL AGENCY: National Park Service

ACREAGE:

(to nearest tenth of an acre)

4 acres

COMMENTS:

(include architectural information here)

Stone, ashlar, 1 story, central block with symmetrical wings, gabled roof sections, interior and exterior end chimneys, center block full-width shed entrance porch, roof sections of heavy timber, sheathed in flagstone, stone pumphouse and garage. Built as a summer residence for world-reknowned geologist, Wallace E. Pratt; His donation of the property to the Park Service formed the nucleus of Guadalupe Mountain National Park.

SIGNIFICANCE:

(maximum two sentences)