

**United States Department of the Interior
Heritage Conservation and Recreation Service**

**National Register of Historic Places
Inventory—Nomination Form**

For HCRS use only

received JUL 5 1979

date entered SEP 7 1979

See instructions in *How to Complete National Register Forms*
Type all entries—complete applicable sections

1. Name

historic Old St. Anthony's Catholic Church

and/or common Violet Museum

2. Location

street & number S. Violet Rd. and TX 44 South Violet Road at Texas State Highway #44 not for publication

city, town Violet vicinity of congressional district 14

state Texas code 048 county Nueces code 355

3. Classification

Category	Ownership	Status	Present Use	
<input type="checkbox"/> district	<input type="checkbox"/> public	<input checked="" type="checkbox"/> occupied	<input type="checkbox"/> agriculture	<input checked="" type="checkbox"/> museum
<input checked="" type="checkbox"/> building(s)	<input checked="" type="checkbox"/> private	<input type="checkbox"/> unoccupied	<input type="checkbox"/> commercial	<input type="checkbox"/> park
<input type="checkbox"/> structure	<input type="checkbox"/> both	<input type="checkbox"/> work in progress	<input type="checkbox"/> educational	<input type="checkbox"/> private residence
<input type="checkbox"/> site	Public Acquisition	Accessible	<input type="checkbox"/> entertainment	<input type="checkbox"/> religious
<input type="checkbox"/> object	<input type="checkbox"/> in process	<input type="checkbox"/> yes: restricted	<input type="checkbox"/> government	<input type="checkbox"/> scientific
	<input type="checkbox"/> being considered	<input checked="" type="checkbox"/> yes: unrestricted	<input type="checkbox"/> industrial	<input type="checkbox"/> transportation
		<input type="checkbox"/> no	<input type="checkbox"/> military	<input type="checkbox"/> other:

4. Owner of Property

name Catholic Diocese of Corpus Christi, Texas (Bishop Thomas J. Drury)

street & number 620 Lipan Street

city, town Corpus Christi vicinity of state Texas 78401

5. Location of Legal Description

courthouse, registry of deeds, etc. Nueces County Courthouse

street & number

city, town Corpus Christi state Texas 78401

6. Representation in Existing Surveys

title Recorded Texas Historic Landmark has this property been determined eligible? yes no

date 1977 federal state county local

depository for survey records Texas Historical Commission

city, town Austin state Texas

7. Description

Condition
 excellent
 good
 fair

deteriorated
 ruins
 unexposed

Check one
 unaltered
 altered

Check one
 original site
 moved date 1975

Describe the present and original (if known) physical appearance

The old St. Anthony's Church (now the Violet Museum) is located in Violet, Texas at the southeast corner of the intersection of Texas State Highway 44 and South Violet Road. Built in 1910, the original structure was a simple, one-story rectangular (26' x 40') wood frame board and batten structure with wood shingled gable roof and an attached gable roofed porch. Each of the sides of the structure was six bays wide, while the front had a window on either side of the door and one centered under the roof ridge. All windows were of the four over four, double hung sash variety. Atop the main roof ridge at the front was a Latin cross, and a five-pointed star embellished the gable end over the porch.

Additions were made to the building in 1919, and horizontal beveled cypress siding was applied. The length of the building was extended, with paired windows added to the side walls at the rear. A single tower was constructed at the center of the back wall, providing room inside for a sculpture niche behind the altar. To provide space for a choir loft, the front of the building was extended and square twin towers were added. The front and sides of the towers have paired windows at the first level and single round windows above. The towers have hipped roofs, but only one is topped by a belfry, which has arched openings and a pyramidal roof crowned by a cross. Double panel doors form the main entrance, which is flanked by small four over four windows. Above the doors are three windows, four over four lights on either side of a six over six opening. A cross tops the main gable at the front. At the time of this remodeling, all the windows were embellished with moldings forming round arches above the window heads. Further decoration is provided by a dentil-like trim under the eaves of the towers and front gable.

An interesting feature of the interior is the ceiling, with its beamed pattern resembling coffers. Around the perimeter is an elaborate 6' tall molding. The top portion (4') is beaver board and milled wood; underneath that is a 2' rolled galvanized metal molding. Interior walls and ceiling of St. Anthony's are beaver board, painted in the original colors of cream with dark brown trim. The flooring also is original, and the exterior colors of cream with rust trim are the same as those used in the early remodeling.

In 1920, the small board and batten rectory which had been built in 1912 was moved, enlarged, and connected with the church itself at the south rear side.

Upon the construction of a new church in 1952, Old St. Anthony's was moved to Clarkwood, four miles away, and served as the St. Anthony's parish mission until 1972, when the Clarkwood congregation built a new church. For three years Old St. Anthony's was not used; but in 1975 the building was again moved, this time returning it to Violet. Through much community effort, the church was restored to its 1920 appearance. The structure is now a community museum.

Many of the early furniture pieces and artifacts, such as the handmade vestment case, baptismal font, altar, and statue groupings have been returned to the church and are displayed in their original locations there.

8. Significance

Period	Areas of Significance—Check and justify below			
<input type="checkbox"/> prehistoric	<input type="checkbox"/> archeology-prehistoric	<input type="checkbox"/> community planning	<input type="checkbox"/> landscape architecture	<input checked="" type="checkbox"/> religion
<input type="checkbox"/> 1400–1499	<input type="checkbox"/> archeology-historic	<input type="checkbox"/> conservation	<input type="checkbox"/> law	<input type="checkbox"/> science
<input type="checkbox"/> 1500–1599	<input type="checkbox"/> agriculture	<input type="checkbox"/> economics	<input type="checkbox"/> literature	<input type="checkbox"/> sculpture
<input type="checkbox"/> 1600–1699	<input checked="" type="checkbox"/> architecture	<input type="checkbox"/> education	<input type="checkbox"/> military	<input type="checkbox"/> social/ humanitarian
<input type="checkbox"/> 1700–1799	<input type="checkbox"/> art	<input type="checkbox"/> engineering	<input type="checkbox"/> music	<input type="checkbox"/> theater
<input type="checkbox"/> 1800–1899	<input type="checkbox"/> commerce	<input type="checkbox"/> exploration/settlement	<input type="checkbox"/> philosophy	<input type="checkbox"/> transportation
<input checked="" type="checkbox"/> 1900–	<input type="checkbox"/> communications	<input type="checkbox"/> industry	<input type="checkbox"/> politics/government	<input type="checkbox"/> other (specify)
		<input type="checkbox"/> invention		

Specific dates 1910, 1919 **Builder/Architect** Rev. Mark Moeslein (alterations)

Statement of Significance (in one paragraph)

The old St. Anthony's Church is significant as an architectural representation of the early South Texas farming community of Violet (originally Land Siding, the name was changed in 1913) which was settled by German Catholics in the early 1900's. German immigrants to Texas in the 19th century were predominantly of the Lutheran faith, and consequently the church is important for its association with German-Catholic Texans. It serves as one of the few reminders of the rural church-centered life which the settlers led. Many of Violet's early structures have been demolished, partly due to highway expansion. However, the church building remains as a charming vernacular architectural expression which exhibits Romanesque Revival stylistic traits. Features of the style used include the two towers and triple window above the entrance. Although the windows themselves are rectangular sash, painted wood molding forms contrasting round-headed arches around each. This typically Romanesque feature is found also in the tower openings. Masonry churches in this style frequently employ brick corbeling for decoration. Here, such a decorative element has been loosely translated to wood, in the trim under the eaves.

Violet was founded by John W. Hoelscher in 1908 as a community of Catholic German-Americans. In 1910, ten acres of land were donated by Louis Petrus to provide a location for a church. Labor for the building was provided free by the parishioners, with John W. Hoelscher serving as foreman and supplying much of the funds to pay for the building materials. The simple rectangular structure served as both the first church and first school for the community.

Because of the community's growth, the structure became inadequate a few years later. The Reverend Mark Moeslein, commuting pastor of St. Anthony's, who is said to have had an architectural background, drew plans to enlarge and remodel the church. Once again, the farmers did the work. Perhaps Rev. Moeslein was recalling a Romanesque church or pictures of one which he had seen. The towers, roofs, and round arch forms suggest this possibility.

After the parishioners had built a new church in 1952, the old church building was moved four miles to Clarkwood, where it served as a mission church until 1972. At that time the Clarkwood congregation built a new church. Old St. Anthony's stood abandoned, but in 1975 it was returned to its first home of Violet, and sited 200 feet east of its original location. The exterior of the building has been restored to its 1920 appearance, and is now the Violet Museum, housing local memorabilia and exhibits about the community's German heritage. The church has integral ties to the Violet community, not only as a

UNITED STATES DEPARTMENT OF THE INTERIOR
HERITAGE CONSERVATION AND RECREATION SERVICE

**NATIONAL REGISTER OF HISTORIC PLACES
INVENTORY -- NOMINATION FORM**

FOR HCRS USE ONLY

RECEIVED

JUL 5 1979

SEP 7 1979

DATE ENTERED

CONTINUATION SHEET

ITEM NUMBER 8 PAGE 1

place of worship, but also as an example of vernacular architecture. Only one professional carpenter was employed, during the 1919 alterations. The early members of the community built this church, later remodeled it, and descendants of those German-Americans were instrumental in restoring the church in the 1970's. The two moves which the church has undergone do not adversely affect the building's historic and cultural integrity. They are, instead, an important part of the structure's evolution from Violet's first church and school, to its parish mission in Clarkwood, and to its present function as a local museum.

9. Major Bibliographical References

St. Anthony's Church records, 1909, translated from German, 1975, Violet, Texas.
"The Story of St. Anthony's, Violet, Texas -- 1921". Rev. Mark Moeslein.
Personal interviews: Loretta Boerner, Christine Hoelscher Gold,

10. Geographical Data

Acreege of nominated property less than one

Quadrangle name Annaville, Tex.

Quadrangle scale 1:24,000

UMT References

A

1	4	6	3	8	4	8	0	3	0	7	3	7	4	0
Zone				Easting				Northing						

B

Zone				Easting				Northing						

C

Zone				Easting				Northing						

D

Zone				Easting				Northing						

E

Zone				Easting				Northing						

F

Zone				Easting				Northing						

G

Zone				Easting				Northing						

H

Zone				Easting				Northing						

Verbal boundary description and justification

Old St. Anthony's Church is located 85 feet from the north boundary of Texas State Highway 44, and 238 feet from the west boundary of South Violet Road. The nominated property encompasses the church with its attached rectory and

List all states and counties for properties overlapping state or county boundaries

state _____ code _____ county _____ code _____

state _____ code _____ county _____ code _____

11. Form Prepared By

name/title Carol Kennedy, Research Assistant

organization Texas Historical Commission date June 27, 1979

street & number P. O. Box 12276, Capitol Station telephone 512-475-3094

city or town Austin state Texas

12. State Historic Preservation Officer Certification

The evaluated significance of this property within the state is:

national state local

As the designated State Historic Preservation Officer for the National Historic Preservation Act of 1966 (Public Law 89-665), I hereby nominate this property for inclusion in the National Register and certify that it has been evaluated according to the criteria and procedures set forth by the Heritage Conservation and Recreation Service.

State Historic Preservation Officer signature

title State Historic Preservation Officer date 6.28.79

For HCRS use only

I hereby certify that this property is included in the National Register

Keeper of the National Register

date 9-7-79

Attest: Beth Groves

date 9/4/79

Chief of Registration

FHR-8-300A
(11/78)

UNITED STATES DEPARTMENT OF THE INTERIOR
HERITAGE CONSERVATION AND RECREATION SERVICE

**NATIONAL REGISTER OF HISTORIC PLACES
INVENTORY -- NOMINATION FORM**

FOR HCRS USE ONLY

RECEIVED

JUL 5 1979

DATE ENTERED

SEP 7 1979

CONTINUATION SHEET

ITEM NUMBER 9

PAGE 1

Edwin Hoelscher, and David Kircher, Violet, Texas.

FHR-8-300A
(11/78)

UNITED STATES DEPARTMENT OF THE INTERIOR
HERITAGE CONSERVATION AND RECREATION SERVICE

**NATIONAL REGISTER OF HISTORIC PLACES
INVENTORY -- NOMINATION FORM**

FOR HCRS USE ONLY

RECEIVED JUL 5 1979

DATE ENTERED

SEP 7 1979

CONTINUATION SHEET

ITEM NUMBER 10 PAGE 1

an apron of fifteen (15') feet around the building.

Property Old St. Anthony's Catholic Church

State TX (Nueces)

Working Number 7.5.79.1607

TECHNICAL

Photos 3

Maps 1

#12 - date

*6.28.79
Per phone
L. Anderson
9/6/79 LRS*

OK

CONTROL

*pl
7.9.79*

Nice vernacular church representing area settlement by German Catholics. Moved in 1852, but moved back a few hundred feet of original location - behind present church. Contains many of the original furnishings.

HISTORIAN

*accept
Brosena
9/4/79*

ARCHITECTURAL HISTORIAN

ARCHEOLOGIST

OTHER

HAER

Inventory _____

Review _____

REVIEW UNIT CHIEF

*accept
B. Grosena
9/4/79*

BRANCH CHIEF

KEEPER

National Register Write-up _____

Federal Register Entry _____

10-2-79

Send-back _____

Re-submit _____

Entered SEP 7 1979



Old St. Anthony's Catholic Church
Violet, Texas *Nueces County*
Danny Hardy, Texas Historical Commission
February, 1979
Texas Historical Commission, Austin, Texas
View looking northeast
Photograph #1

JUL 5 1979



Nueces County

Old St. Anthony's Catholic Church

Violet, Texas

Danny Hardy, Texas Historical Commission

February, 1979

Texas Historical Commission, Austin, Texas

View of north elevation

Photograph #2

JUL 5 1979

SEP 7 1979



Old St. Anthony's Catholic Church
Violet, Texas
Danny Hardy, Texas Historical Commission
February, 1979
Texas Historical Commission, Austin, Texas
View looking northwest
Photograph #3

Nueces County

JUL 5 1979

SEP 7 1979

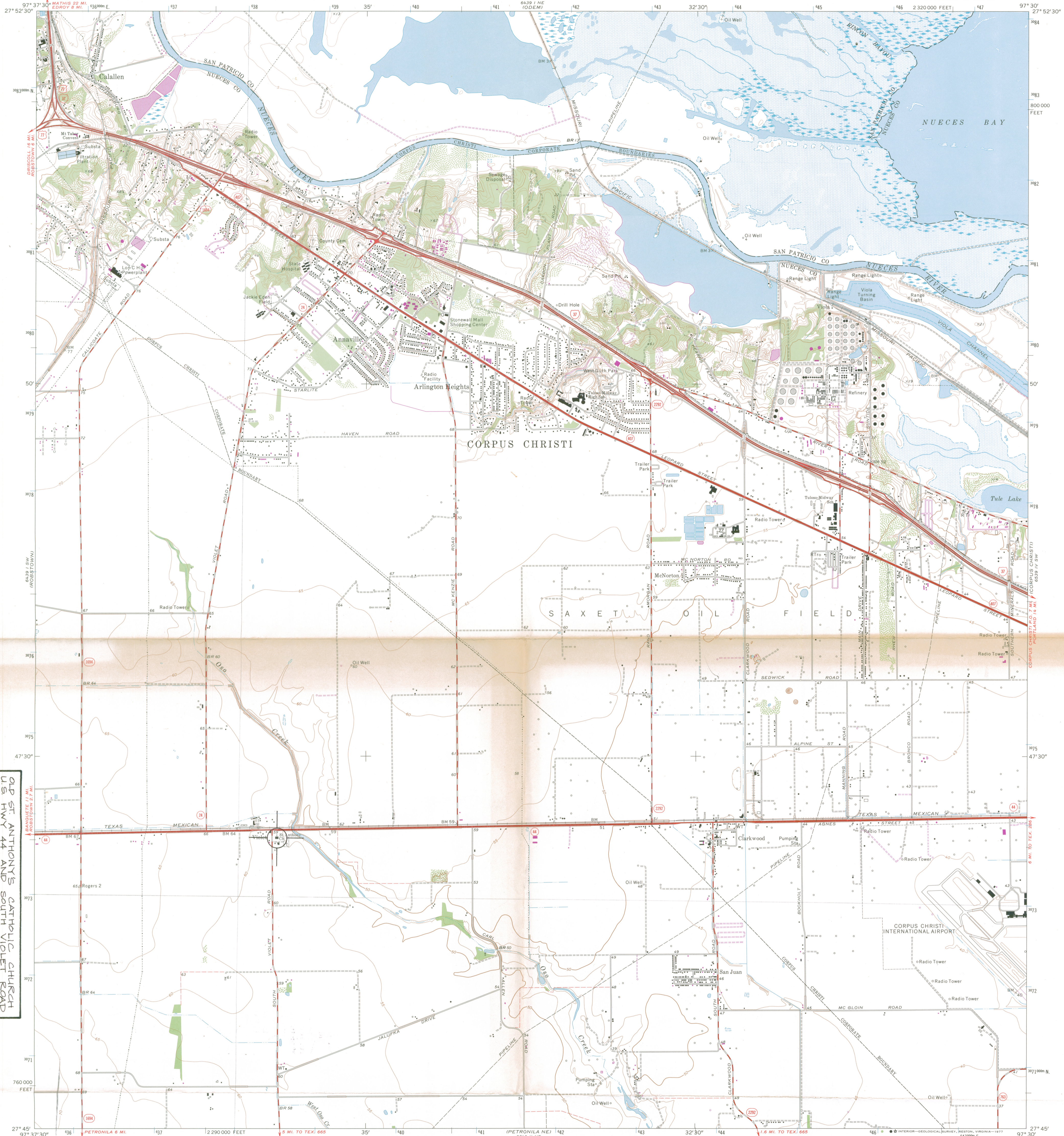

OLD ST ANTHONY'S CATHOLIC CHURCH
US HWY 44 AND SOUTH VIOLET ROAD
VIOLET NUECES COUNTY TEXAS
UTM REF: 14/638490/3073740

Mapped, edited, and published by the Geological Survey
Control by USGS and NOS/NOAA
Topography by photogrammetric methods from aerial
photographs taken 1968. Field checked 1969
Polyconic projection. 1927 North American datum
10,000-foot grid based on Texas coordinate system,
south zone
1000-meter Universal Transverse Mercator grid ticks,
zone 14, shown in blue
Fine red dashed lines indicate selected fence lines
Water stages in this area vary with meteorological conditions
Approximate limits of occasional inundation shown by dashed blue lines
where mean high water is undetermined for lack of visual evidence
Dotted blue lines indicate the approximate limits of low water

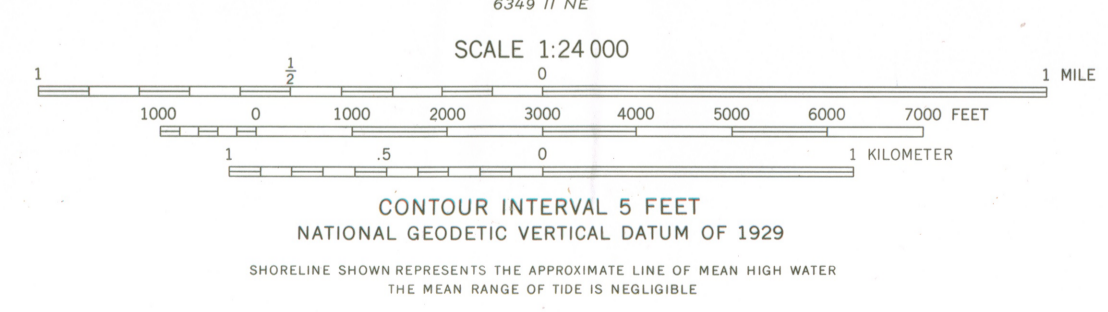
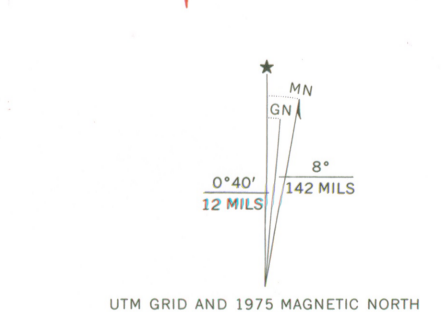

ROAD CLASSIFICATION
Primary highway, all weather, hard surface
Secondary highway, all weather, hard surface
Light-duty road, all weather, improved surface
Unimproved road, fair or dry weather
Interstate Route
U.S. Route
State Route

ANNVILLE, TEX.
SE/4 ROBSTOWN 15' QUADRANGLE
N2745-W9730/7.5

1969
PHOTOREVISED 1975
AMS 6439 I SE--SERIES V882

RECEIVED
JUL 5 1979
NATIONAL REGISTER

2797-341

SEP 7 1979

THIS MAP COMPLIES WITH NATIONAL MAP ACCURACY STANDARDS
FOR SALE BY U.S. GEOLOGICAL SURVEY, DENVER, COLORADO 80225 OR RESTON, VIRGINIA 22092
A FOLDER DESCRIBING TOPOGRAPHIC MAPS AND SYMBOLS IS AVAILABLE ON REQUEST

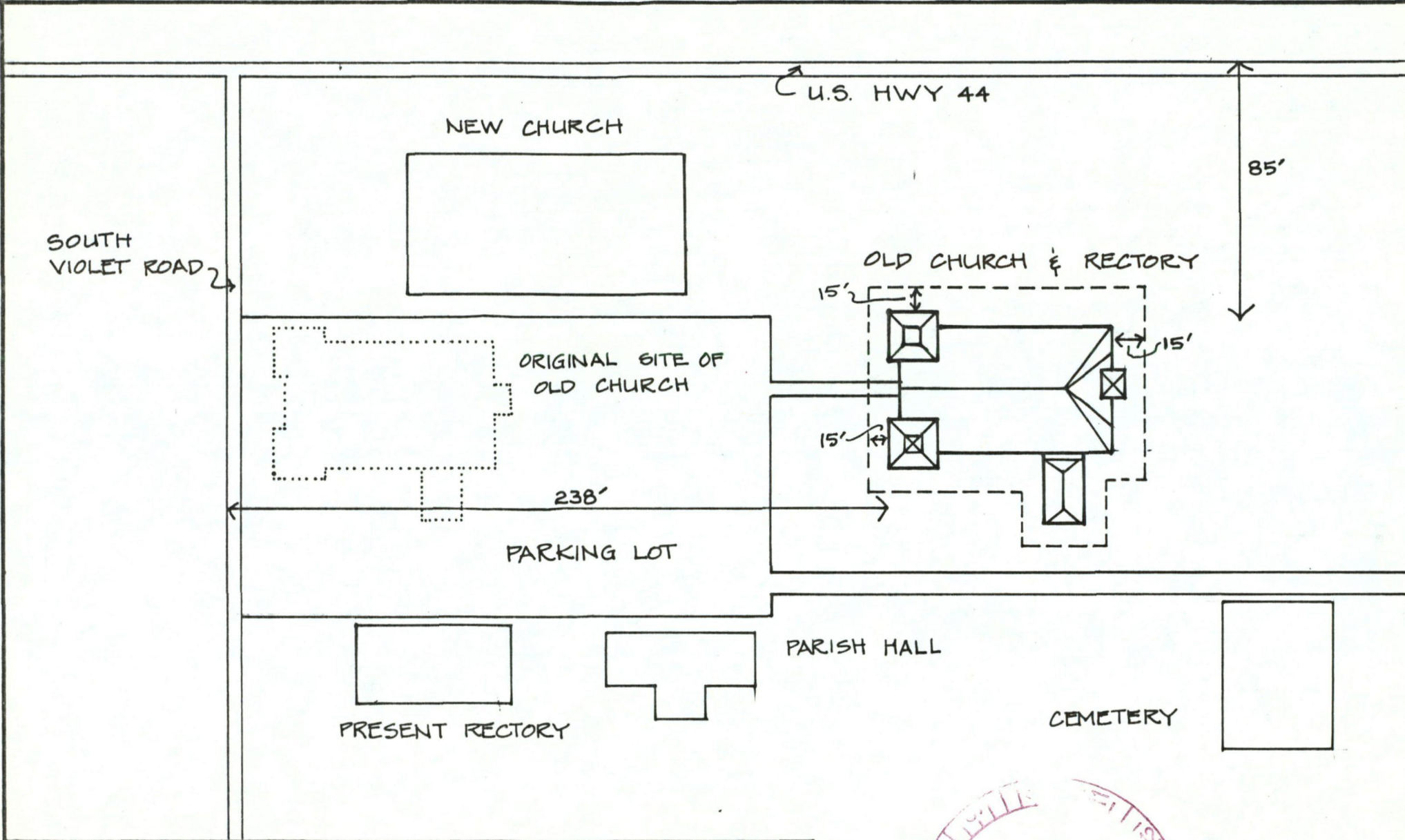

OLD ST. ANTHONY'S CATHOLIC CHURCH

U.S. HWY 44 AT SOUTH VIOLET ROAD
 VIOLET, NUECES COUNTY, TEXAS

NO SCALE

----- NATIONAL REGISTER BOUNDARY

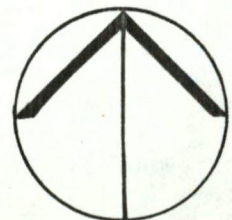

SEP 7 1979

ENTRIES IN THE NATIONAL REGISTER

STATE TEXAS

Date Entered SEP 7 1979

<u>Name</u>	<u>Location</u>
Old St. Anthony's Catholic Church	Violet Nueces County

Also Notified

Honorable Lloyd M. Bentsen

Honorable John G. Tower
Honorable Joseph P. Wyatt

State Historic Preservation Officer
Mr. Truett Latimer
Executive Director
Texas State Historical Commission
P.O. Box 12276, Capitol Station
Austin, Texas 78711

NR Byers/bjr 9/13/79

CODING PROBLEM SHEET

State Name Texas County Name Mueces Resource Name old St. Anthony's Catholic Church
 Multiple Name _____
 Reference No. 79003003 Certification Date 9-7-79

Problem Field:

- | | | |
|--|--|---|
| <input type="checkbox"/> Owner | <input type="checkbox"/> Applicable Criteria | <input type="checkbox"/> Cultural Affiliation |
| <input type="checkbox"/> Resource Type | <input type="checkbox"/> Criteria Considerations | <input type="checkbox"/> Architectural Style |
| <input type="checkbox"/> No. Contrib./Non-Contrib. Resources | <input checked="" type="checkbox"/> Area of Significance | <input type="checkbox"/> Construction Materials |
| <input type="checkbox"/> Historic Function/Historic Sub-function | <input type="checkbox"/> Period of Significance | <input type="checkbox"/> Acreage |
| <input type="checkbox"/> Current Function/Current Sub-function | <input type="checkbox"/> Architect/Builder/Engineer | <input type="checkbox"/> UTM Coordinates |
| <input type="checkbox"/> Level of Significance | <input type="checkbox"/> FR Level Information | <input type="checkbox"/> Other |

Solution:

Coding Problem Team: _____ Date: _____ NR Staff: _____ Date: _____

Data Collector's Explanation of Problem:

Religion not justified (A function)

Data Collector: Other Today's Date 1-27-83 D.B. Corrected _____ Date _____